



**RFP – 22-01**  
**LEAK CORRECTION,**  
**REPLASTER AND EXPANSION**  
**JOINT REPLACEMENT**

---

**DELLINGER PARK POOL**

---

September 10, 2021

# City of Cartersville, Georgia

RFP – 22-01

LEAK CORRECTION, REPLASTER AND EXPANSION JOINT REPLACEMENT

## TABLE OF CONTENTS

<b><u>ITEM</u></b>	<b><u>PAGE</u></b>
TABLE OF CONTENTS	2
REQUEST FOR PROPOSALS	3
INSTRUCTIONS TO PROPOSERS **Mandatory Pre-Bid Meeting	3-4
CONTRACTOR QUALIFICATIONS	4
PROPOSAL CLOSING TIME	4
BID OPENING	4
PROJECT SCOPE – LEAK CORRECTION, REPLASTER AND EXPANSION JOINT REPLACEMENT	5-7
PROPOSAL REQUIREMENTS	8
PROPOSAL FORM	9
REFERENCES	10
CONTRACT AGREEMENT	11-12
CONTRACTOR/VENDOR AFFIDAVIT	13
SUBCONTRACTOR AFFIDAVIT	14
EXHIBIT A -SKYVIEW OF DELLINGER PARK POOL	15
EXHIBIT B- W.R. MEADOWS SUBMITTAL PACKAGE	16
EXHIBIT C-MIRACOTE SUBMITTAL	37

**CITY OF CARTERSVILLE, GEORGIA**

RFP – 22-01

# **LEAK CORRECTION, REPLASTER AND EXPANSION JOINT REPLACEMENT**

## **REQUEST FOR PROPOSALS**

The City of Cartersville, Georgia invites your company to submit a Proposal on this Proposal Package, titled: **LEAK CORRECTION, RE-PLASTER AND EXPANSION JOINT REPLACEMENT** as defined hereinafter.

All terms and provisions listed in the enclosed: “TABLE OF CONTENTS”, “REQUEST FOR PROPOSALS”, “INSTRUCTIONS TO PROPOSERS”, “PROJECT SPECIFICATIONS” AND “PROPOSAL FORM” are integral parts of the Proposal Package.

The City of Cartersville reserves the right to waive informalities in any Proposal, to reject any or all Proposals in whole or in part, to readvertise, to negotiate segments of any or all Proposals and to take any action that City feels is in our best interest.

The proposal price(s) will include: The renovations include items listed in the table of contents to the entire structure located at 100 Pine Grove Road, Cartersville, GA 30120. Contractors may bid on the entire project or items listed in the table of contents.

## **INSTRUCTIONS TO PROPOSERS**

1. To be considered, Proposals must be in the possession of the City of Cartersville by the Proposal Closing. Proposals may be mailed or delivered to the office of Tom Gilliam, Director of Parks & Recreation, City of Cartersville, P O Box 1390, 100 Pine Grove Road, Cartersville GA 30120, in a sealed envelope clearly marked as to the item being proposed and marked with the time and date of Proposal Closing. Regardless of the method the Proposer uses to deliver the Proposal, each Proposer shall be responsible for the Proposal being delivered on time as the City of Cartersville assumes no responsibility for the same. Proposals offered or received after the time set for Proposal Closing will not be considered.
2. No Proposal may be withdrawn for a period of 60 days from the Proposal Closing Date.
3. All Proposals are to be submitted on the “Proposal Form” provided in this Proposal Package and signed by an authorized representative of the company placing the Proposal.
4. **\*A MANDATORY Pre-proposal meeting will take place Wednesday, September 22, 2021 10:00am at the Dellinger Park Pool, 100 Pine Grove Road, Cartersville, GA 30120**

## **INSTRUCTIONS TO PROPOSERS - CONTINUED:**

5. The City of Cartersville is exempt from Federal, State, and Local Taxes. Taxes incurred by the Contractor during this project shall be to the account of the Contractor.
6. Proposers shall not begin any work activity until such time as they have been issued a Notice to Proceed by the City of Cartersville.
7. E-verify/SAVE Affidavits – Completed/signed/notarized affidavits **must be** returned with Proposal Deadline or Proposal will not be considered. Forms included in Proposal.
8. Immigration Reform Compliance Requirement, during the entire duration of this project contractor shall remain in compliance with Georgia Security and Immigration Compliance Act of 2007 and Georgia code § 13- 10- 91 and § 50- 36- 1, as amended.
9. For additional information on this Proposal Package and to view site, contact: Megan Hix, Aquatics Manager of Parks & Recreation, City of Cartersville, via email at [mhix@cityofcartersville.org](mailto:mhix@cityofcartersville.org)

## **REQUIRED QUALIFICATIONS OF PROPOSERS/CONTRACTOR**

The Contractor must be a certified in his/her trade. The Contractor shall have a valid business license in the State of Georgia and be able to show financial responsibility and have the ability to provide bonds and certificates of insurance.

### **PROPOSAL CLOSING TIME**

**The Proposal Closing will be 3:00 p.m. on Thursday, October 7, 2021.**

### **PROPOSAL OPENING TIME**

**The Proposal Opening time will be 3:30 p.m. on Thursday, October 7, 2021**

**Location: Dellinger Park Office 100 Pine Grove Road, Cartersville, GA 30120**

# City of Cartersville, Georgia

## LEAK CORRECTION, REPLASTER AND EXPANSION JOINT REPLACEMENT

### PROJECT SCOPE

#### PURPOSE -

The Work Scope of this Technical Provision will include: to provide all materials and labor by a certified/ licensed contractor to complete all **LEAK CORRECTION, REPLASTER AND EXPANSION JOINT REPLACEMENT** listed under the PROJECT SCOPE to complete the DELLINGER PARK POOL.

#### DEFINITION -

For all purposes and requirements of this document, the words “provide” and “provided” shall be defined as the requirement to furnish a service, or to furnish a product system, or facility in its entirety.

#### MATERIALS

A list of materials will be provided and specified to be provided by the contractor.

#### POOL SIZE –

Pool Size –228,000 gallons the major depth ranges marked are from Zero Depth to Shallow consisting of 1ft 6in, 1ft 8in, 2ft, graduating to the “T” area consisting of 3ft, 4ft, finally leading into the Deep/Diving/ Competition area 5-7ft, 9ft and 10ft. Seven lane lines in the competition area 75ft X 50 ft. Pool also contains entry steps, in-water permanent bulkhead, three ladders, underwater lighting.

### PROJECT SPECIFICATIONS

#### A. LEAK CORRECTION

For Gutter Leak Repair:

1. During Plaster Prep, Chip plaster around entire gutter 2" down.
2. Tape and protect gutter and all return inlets in the gutter prior to waterproofing with Miracote.
3. Use the Miracote Crack Repair System as detailed in the drawing for Crack Treatment Detail.

For Surge Chamber Repairs:

1. For Waterproofing Pipe Penetrations and the Converter Box Flume in the Surge Chamber use the Miracote Pipe Detail Drawing for specifications and then waterproof the entire surge chamber with 2 coats of Miracote 30 mils each coat.
2. For cracks in corners use the Miracoat Change in Plane detail drawing for specifications.

For Any Cracks Discovered in Floor or Walls of Pool and Zero-Entry Grates:

1. Use the Miracoate Crack Repairs System as detailed in the drawing for Crack Treatment Detail.

**B. EXPANSION JOINT REPAIR:**

1. Remove 6" of plaster on each side of the joint, then remove and clean out 6" of material from inside of expansion joint.
2. Use the Miracote Expansion Joint Detail for specifications to waterproof 6" on each side of expansion joint and install a row of 2"x2" frost-proof, non-glazed tile, color artic white (daltile d617), on each edge of expansion joint. Tape and protect all tile work after grout cures.
3. Install WR Meadows Self-Expanding Cork Expansion 4"-6" into the clean joint. May use Backer Rod to make up for any dimensional difference as needed prior to caulking.
4. Prime over inside walls of expansion joint and tile edges with WR Meadows Rezi-Weld LV Primer. Allow to cure according to specifications.
5. Install WR Meadows 2-Part Gun Grade Dec-O-Seal, color white, and allow to cure 72 hours minimum prior to pool plaster application.

**C. REPLASTER**

1. Draining the pool by City of Cartersville Parks & Recreation Maintenance Staff
2. Sound test entire pool for any delaminated plaster
3. Repair any delaminated/worn plaster, saw cut out any cracks in the pool and apply an epoxy material
4. Scarify the pool surface and prep for adhesive
5. Apply Kover Krete Pre-Kote System to ensure a bond between the old and new plaster. The product also strengthens the new plaster.
6. Saw cut under and around gutter, main drains, returns, etc.
7. Apply white plaster mix (minimum 3/8" thick) and trowel to a smooth finish. Plaster mix will be a 3 to 5 ratio, Portland to pool mix marble.
8. The pool will be filled immediately by City of Cartersville Parks & Recreation Maintenance Staff.
9. Contractor will provide proper water chemistry to ensure proper curing of the new plaster.
10. Supply sequestering agent to eliminate staining by minerals in the fill water
11. City of Cartersville Parks & Recreation Maintenance Staff will be responsible for brushing pool for approximately 2-3 weeks to ensure proper curing of new plaster.
12. Include replacing floor returns, replacing the 18" X 18" main drain covers, Zero depth entry grates.

**D. LANE LINES & BREAKLINE TILE:**

1. Remove the lane line tile that is delaminated or hollow
2. All tile will be 2" X 2" non-skid black tile. Lanes will be set 12" wide
3. Grout in new tile

**E. UNDERWATER POOL LIGHTING REPLACEMENT:**

1. Replace five current lighting with LED fixtures.

F. All questions should be emailed to mhix@cityofcartersville.org No phone calls are to be directed the City of Cartersville Staff or the Project Manager regarding questions.

G. Proposal closing date – **Thursday, October 7, 2021** at 3:00pm.

Proposal opening date – **Thursday, October 7, 2021** at 3:30pm at Dellinger Park Office located at 100 Pine Grove Road, Cartersville, GA 30120.

H. Work Completion – Materials are expected to be completed within the time frame established in the project calendar by the Project Manager. The Project Manager will provide advanced start and completion dates to the Contractor. Coordination between contractors and Parks & Recreation Director will take place prior to Proposal award.

I. Certificate of Insurance – Proposers must furnish certificate of insurance covering company and installers/contractors at time bonds are presented. City of Cartersville assumes no responsibility in workman's compensation.

J. License- The contractor shall hold a business license and provide documentation of their certification/s.

-----**END OF PROJECT SPECIFICATIONS**-----

## **PROPOSAL REQUIREMENTS**

**Note: For a Proposal to be considered the following must be returned by the Proposal deadline of 3:00pm on Thursday, October 7, 2021.**

- 1. Completed proposal form**
- 2. Certification of Liability Insurance**
- 3. Completed list of references**
- 4. Completed Contractor/Vendor Affidavit and Agreement**
- 5. Completed Subcontractor Affidavit (if applicable)**



# City of Cartersville, Georgia

LEAK CORRECTION, REPLASTER AND EXPANSION JOINT REPLACEMENT

## PROPOSAL FORM

TO: Tom Gilliam (Dellinger Park Pool Leak Correction, Replaster, Expansion joint replacement Proposal)  
CITY OF CARTERSVILLE PARKS & RECREATION DEPARTMENT  
P O BOX 1390  
CARTERSVILLE GA 30120-1390

PROPOSERS:

IN ACCORDANCE WITH REQUIREMENTS OF YOUR INVITATION TO PROPOSERS, INSTRUCTIONS TO PROPOSERS, AND PROJECT SPECIFICATION, AND SUBJECT TO THE CONDITIONS THEREOF, I, THE UNDERSIGNED, HEREBY PROPOSE TO PROVIDE THE DELLINGER PARK POOL REPLASTERING FOR MONETARY CONSIDERATIONS.

---

A. LUMP SUM PROPOSAL PRICE FOR WORK SCOPE ITEMS, LISTED HEREIN, FOR ANY OR ALL OF THE PROJECTS LISTED UNDER SCOPE OF WORK AND PROJECT SPECIFICATIONS

\$ \_\_\_\_\_

B. LUMP SUM PROPOSAL FOR WORK SCOPE ITEMS, LISTED HEREIN, FOR EXPANSION JOINT REPLACEMENT ONLY, REMOVE THE COMPLETE EXISTING EXPANSION JOINT AND MATERIAL, REPLACE WITH NEW EXPANSION JOINT AND ALL NEW MATERIAL, INSTALL NEW UNDERWATER APPROVED CAULK AND INSTALL NEW TILE.

\$ \_\_\_\_\_

C. LUMP SUM PROPOSAL FOR WORK SCOPE ITEMS, LISTED HEREIN, FOR REPLASTER, LANE AND BREAKLINE TILE, REMOVE THE EXISTING PLASTER AND MATERIAL, REPLACE WITH NEW PLASTER AND ALL NEW MATERIAL, AND INSTALL NEW TILE.

\$ \_\_\_\_\_

---

PROPOSERS: \_\_\_\_\_ BY: \_\_\_\_\_

TITLE: \_\_\_\_\_ SIGNATURE: \_\_\_\_\_

ADDRESS: \_\_\_\_\_

\_\_\_\_\_

PHONE NUMBER: \_\_\_\_\_

\_\_\_\_\_

## **REFERENCES**

NAME, ADDRESS, AND PHONE NUMBER OF FOUR- (4) SUCCESSFUL PROJECTS THE PROPOSERS HAS COMPLETED.

1. COMPANY NAME: \_\_\_\_\_

ADDRESS: \_\_\_\_\_

CONTACT PERSON: \_\_\_\_\_ PHONE NO. \_\_\_\_\_

EMAIL ADDRESS: \_\_\_\_\_

2. COMPANY NAME: \_\_\_\_\_

ADDRESS: \_\_\_\_\_

CONTACT PERSON: \_\_\_\_\_ PHONE NO. \_\_\_\_\_

EMAIL ADDRESS: \_\_\_\_\_

3. COMPANY NAME: \_\_\_\_\_

ADDRESS: \_\_\_\_\_

CONTACT PERSON: \_\_\_\_\_ PHONE NO. \_\_\_\_\_

EMAIL ADDRESS: \_\_\_\_\_

4. COMPANY NAME: \_\_\_\_\_

ADDRESS: \_\_\_\_\_

CONTACT PERSON: \_\_\_\_\_ PHONE NO. \_\_\_\_\_

EMAIL ADDRESS: \_\_\_\_\_

---

**Contract Agreement**

**LEAK CORRECTION, REPLASTER AND EXPANSION JOINT REPLACEMENT**

This Contract Agreement made and entered into on the \_\_\_\_\_ day of \_\_\_\_\_, 2021, by and between the CITY OF CARTERSVILLE, party of the first part (hereinafter called the “Owner”), and \_\_\_\_\_, party of the second part, (herein called the “Contractor”).

**Witnesseth:**

That the Contractor, for the consideration hereinafter fully set out, hereby agrees with the Owner as follows:

That the Contractor will furnish all products, tools, construction equipment, skill labor of every description necessary to carry out and to complete in a good, firm, substantial workmanlike manner for the leak correction, re-plastering and expansion joint replacement at the Dellinger Park Pool and will complete work in strict conformity with the Specifications, together with the foregoing Proposal made by the Contractor, the Invitation to Proposal, Instructions to Proposers, Project Specifications and Proposal Form and all hereto incorporated (if applicable) which form essential parts of this Contract Agreement, as if fully contained herein.

That the Contractor shall commence the work to be performed under this Contract Agreement on a date to be specified in a written Notice to Proceed and shall fully complete all work hereunder within three (3) weeks of the agreed upon start date. Time is of the essence and is an essential element of this Contract, and the Contractor may be subject to pay the Owner, not as a penalty, but as liquidated damages, the sum of \$250.00 for each calendar day that there is default of completing the work within the time limit named herein. If the Contractor abandons the Contract before commencement of the work or defaults in completion of all the work after commencement thereof, the Contractor shall be liable for such liquidated damages. These fixed liquidated damages are not established as a penalty but are calculated and agreed upon in advance by the Owner and the Contractor due to the uncertainty and impossibility of deciding as to the actual and consequential damages incurred by the Owner and the public of City of Cartersville, Georgia because of the failure on the part of the Contractor to complete the work on time. Such liquidated damages referred to herein are intended to be and are cumulative and shall be in addition to every other remedy now or hereafter enforceable at law, in equity, by statute, or under the Contract.

The Owner hereby agrees to pay the Contractor for the faithful performance of this Contract Agreement, subject to additions and deductions as provided in the Specifications and Proposal, in lawful money of the United States of America, the sum \_\_\_\_\_(\_\_\_\_\_)

which sum shall also pay for loss or damage arising out of the nature of the work aforesaid, or from the action of the elements, or from unforeseen, or from the action of the elements, or from unforeseen obstructions or difficulties encountered in the prosecution of the work, and for all expenses incurred by, or in consequence of the work, its suspension or discontinuance and for well and faithfully completing the work and the whole thereof, as herein provided, and for replacing defective work or products for a period of two –(2) years after completion.

The Owner shall make payments to the Contractor in accordance with the provisions of the Contract Documents.

Final payment on account of this Contract Agreement shall be made within thirty – (30) days after the completion by the Contractor of all work covered by this Contract Agreement and the acceptance of such work by the Owner, in accordance with the provisions of the Contract Documents.

**IN WITNESS WHEREOF**, the parties hereto executed this Contract Agreement under their respective seals on the day and date first above written.

**OWNER:** City of Cartersville, Georgia

By: \_\_\_\_\_

Matthew J. Santini

Title: Mayor

**WITNESS:** By: \_\_\_\_\_(SEAL)

Julia Drake

Title: City Clerk

**CONTRACTOR:** \_\_\_\_\_

By: \_\_\_\_\_

Name: \_\_\_\_\_

(Please Print)

Title: \_\_\_\_\_

SUBSCRIBED AND SWORN BEFORE ME ON THIS THE \_\_\_\_ DAY OF \_\_\_\_\_,  
20\_\_\_\_

\_\_\_\_\_  
Notary Public

My Commission Expires:  
\_\_\_\_\_

**CONTRACTOR/VENDOR AFFIDAVIT AND AGREEMENT**

By executing this affidavit, the undersigned contractor verifies its compliance with O.C.G.A. 13-10-91, stating affirmatively that the individual, firm, or corporation which is contracting with City of Cartersville has registered with and is participating in a federal work authorization program\* [any of the electronic verification of work authorization programs operated by the United States Department of Homeland Security or any equivalent federal work authorization program operated by the United States Department of Homeland Security to verify information of newly hired employees, pursuant to the Immigration Reform and Control Act of 1986 (IRCA), P.L. 99-603], in accordance with the applicability provisions and deadlines established in O.C.G.A. 13-10-91.

The undersigned further agrees that, should it employ or contract with any subcontractor(s) in connection with the physical performance of services pursuant to this contract with City of Cartersville, contractor will secure from such subcontractor(s) similar verification of compliance with O.C.G.A. 13-10-91 on the Subcontractor Affidavit provided in Rule 300-10-01-.08 or substantially similar form. Contractor further agrees to maintain records of such compliance and provide a copy of each such verification to the City of Cartersville at the time the subcontractor(s) is retained to perform such service.

The undersigned Contractor is using and will continue to use the federal work authorization program throughout the contract period.

\_\_\_\_\_  
EEV/Basic Pilot Program\* User Identification Number

\_\_\_\_\_  
BY: Authorized Officer or Agent  
(Contractor Name)

\_\_\_\_\_  
Date

\_\_\_\_\_  
Contractor/Entity Name

\_\_\_\_\_  
Title of Authorized Officer or Agent of Contractor

\_\_\_\_\_  
Contractor Address

\_\_\_\_\_  
Printed Name of Authorized Officer or Agent

SUBSCRIBED AND SWORN  
BEFORE ME ON THIS THE  
\_\_\_\_ DAY OF \_\_\_\_\_, 20\_\_\_\_

\_\_\_\_\_  
Notary Public  
My Commission Expires:  
\_\_\_\_\_

\* As of the effective date of O.C.G.A. 13-10-91, the applicable federal work authorization program is the "EEV/Basic Pilot Program" operated by the U.S. Citizenship and Immigration Services Bureau of the U.S. Department of Homeland Security, in conjunction with the Social Security Administration (SSA).

**SUBCONTRACTOR AFFIDAVIT**

By executing this affidavit, the undersigned subcontractor verifies its compliance with O.C.G.A. 13-10-91, stating affirmatively that the individual, firm or corporation which is engaged in the physical performance of services under a contract with \_\_\_\_\_ (name of contractor) on behalf of City of Cartersville has registered with and is participating in federal work authorization program being\* [any of the electronic verification of work authorization programs operated by the United States Department of Homeland Security or any equivalent federal work authorization program operated by the United States Department of Homeland Security to verify information of newly hired employees, pursuant to the Immigration Reform and Control Act of 1986 (IRCA), P.L. 99-603], in accordance with the applicability provisions and deadlines established in O.C.G.A. 13-10-91.

The undersigned subcontractor is using and will continues to use the federal work authorization program throughout the contract period.

\_\_\_\_\_  
EEV/Basic Pilot Program\* User Identification Number

\_\_\_\_\_  
BY: Authorized Officer or Agent  
(Subcontractor Name)

\_\_\_\_\_  
Date

\_\_\_\_\_  
Title of Authorized Officer or Agent of Subcontractor

\_\_\_\_\_  
Printed Name of Authorized Officer or Agent

SUBSCRIBED AND SWORN  
BEFORE ME ON THIS THE  
\_\_\_\_ DAY OF \_\_\_\_\_, 20\_\_\_\_

\_\_\_\_\_  
Notary Public  
My Commission Expires:  
\_\_\_\_\_

\* As of the effective date of O.C.G.A. 13-10-91, the applicable federal work authorization program is the “EEV/Basic Pilot Program” operated by the U.S. Citizenship and Immigration Services Bureau of the U.S. Department of Homeland Security, in conjunction with the Social Security Administration (SSA).

## EXHIBIT A





# Submittal Package

800-342-5976  
[www.wrmeadows.com](http://www.wrmeadows.com)

# Table of Contents:

SELF-EXPANDING CORK EXPANSION JOINT

## Product Data Sheet

SELF-EXPANDING CORK EXPANSION JOINT

## Safety Data Sheet

SELF-EXPANDING CORK EXPANSION JOINT

## Guide Specification

DECK-O-SEAL GUN GRADE

## Product Data Sheet

DECK-O-SEAL GUN GRADE

## Safety Data Sheet: Base

DECK-O-SEAL GUN GRADE

## Safety Data Sheet: Setting Agent

DECK-O-SEAL GUN GRADE

## REZI-WELD LV Priming Installation Guidelines

## SELF-EXPANDING CORK EXPANSION JOINT

### Expansion/Contraction Control Joint

#### DESCRIPTION

SELF-EXPANDING  
EXPANSION

CORK

JOINT is formed and compressed under heat and pressure to permit expansion up to 140% of original thickness after installation, which permits the filler to compensate for concrete shrinkage. Normal humidity conditions after installation activate the self-expanding properties of the cork. Product may be cut on jobsite to exact size required.

#### USES

SELF-EXPANDING  
EXPANSION

CORK

JOINT is used where high resiliency is needed, such as in sewage plants, floodwalls, spillways, filtration plants, and numerous commercial and industrial applications. SELF-EXPANDING CORK EXPANSION JOINT is especially desirable where a constant friction-fit is required.

#### FEATURES/BENEFITS

- High resiliency with excellent recovery after compression.
- Protects against water infiltration when properly sealed.
- Easy to handle and install.
- Offers isolation capabilities.

#### PACKAGING

Thickness Widths	Slab Widths	Standard Lengths
½" (12.7 mm)	24"	3'
¾" (19.05 mm)	(610 mm)	(.91 m)
1" (25.4 mm)		

#### SPECIFICATIONS

- AASHTO M 153, Type III
- ASTM D 1752, Type III
- Corps of Engineers CRD-C 509, Type III
- FAA Specification Item P-610-2.7
- Federal Specification HH-F-341 F, Type II, Class C

#### APPLICATION

The type of control joint and spacing used will vary with each project according to the type of structure, climatic conditions, and anticipated stresses in the concrete. Thinner joints of ¼" (6.35 mm), ⅜" (9.53 mm), or ½" (12.7 mm),

spaced at frequent intervals, offer greater control than thicker joints spaced at greater intervals. The basic objective is to provide ample room for the concrete to expand or contract without creating damaging stresses. Expansion joints should be positioned against forms at interrupting objects or columns and against abutting structures prior to the placement of the concrete. CORK EXPANSION JOINT should be recessed ½" (12.7 mm) below the concrete surface to accept the joint sealant. To isolate filler from sealant, use SNAP-CAP® from W. R. MEADOWS. SELF-EXPANDING CORK EXPANSION JOINT

should be installed in a concrete joint within 24 hours of pouring. The moisture present in the concrete and the heat of hydration is typically sufficient to cause the product to fully expand. NOTE: When installed in existing concrete, it will be necessary to apply clean, hot water [ $>180^{\circ}\text{F}$  ( $82.2^{\circ}\text{C}$ )] to the exposed edges of the cork to facilitate expansion. A pressure washer capable of producing hot water or a steam cleaner may be used to produce the hot water.

SNAP-CAP should be installed flush with the surface. After removal of the top section of SNAP-CAP, the joint opening is ready for sealing with a suitable sealant from W. R. MEADOWS.

**CONTINUED ON REVERSE SIDE...**

DECK-O-SEAL®, POURTHANE NS, POURTHANE SL, and SOF-SEAL® are suitable sealants for horizontal applications of SELF-EXPANDING CORK EXPANSION JOINT. Hot-applied sealants such as 3405 and HI-SPEC® from W. R. MEADOWS are also compatible. The recommended sealants for vertical applications are DECK-O-SEAL GUN GRADE and POURTHANE NS.

### LEED INFORMATION

May help contribute to LEED credits:

- MR Credit 2: Construction Waste Management
- MR Credit 5: Regional Materials
- MR Credit 6: Rapidly Renewable Materials

For further LEED information and safety data sheet, visit [www.wrmeadows.com](http://www.wrmeadows.com).



### LIMITED WARRANTY

W. R. MEADOWS, INC. warrants at the time and place we make shipment, our material will be of good quality and will conform with our published specifications in force on the date of acceptance of the order. Read complete warranty. Copy furnished upon request.

### Disclaimer

The information contained herein is included for illustrative purposes only, and to the best of our knowledge, is accurate and reliable. W. R. MEADOWS, INC. cannot however under any circumstances make any guarantee of results or assume any obligation or liability in connection with the use of this information. As W. R. MEADOWS, INC. has no control over the use to which others may put its product, it is recommended that the products be tested to determine if suitable for specific application and/or our information is valid in a particular circumstance. Responsibility remains with the architect or engineer, contractor and owner for the design, application and proper installation of each product. Specifier and user shall determine the suitability of products for specific application and assume all responsibilities in connection therewith.



# SAFETY DATA SHEET

SECTION 1: PRODUCT AND COMPANY IDENTIFICATION							
<b>Product:</b>	<b>SELF-EXPANDING CORK EXPANSION JOINT</b>			<b>Part Number: 3240030</b>			
<b>Manufacturer:</b>	<b>W. R. MEADOWS, INC.</b>			<b>Address: 300 Industrial Drive Hampshire, Illinois 60140</b>			
<b>Telephone:</b>	(847) 214-2100			In case of emergency, dial (800) 424-9300 (CHEMTREC)			
<b>Revision Date:</b>	12/31/2019						
<b>Product Use:</b>	Expansion Joint in Concrete Construction						
SECTION 2: HAZARDS IDENTIFICATION/EXPOSURE LIMITS							
<b>HMS</b>							
<b>  Health  </b>	0	Product is classified as non-hazardous per OSHA 1910.1200. Cork Expansion Joint is defined by OSHA as an "article." A manufactured item that is formed to a specific shape or design during manufacture that does not release or result in exposure to a hazardous					
<b>  Flammability  </b>	0						
<b>  Reactivity  </b>	0						
<b>  Personal Protection  </b>		chemical under normal use conditions.					
SECTION 3: HAZARDS COMPONENTS							
<b>% by Chemical Name:</b>	<b>CAS Number</b>	<b>Weight</b>	<b>SARA 313</b>	<b>Vapor Pressure (mm Hg@20°C)</b>	<b>LEL (@24°C)</b>		
1. None							
Under the reporting requirements of Section 313 of Title III of the Superfund Amendments and Reauthorization Act of 1966 (SARA) and 40 CFR Part 372, chemicals listed on the 313 List (40 CFR Part 373.65) are identified under the heading "SARA 313."							
SECTION 4: EMERGENCY AND FIRST AID PROCEDURES							
<b>EYE CONTACT:</b> Flush eyes with water to remove particles							
<b>SKIN CONTACT:</b> Flush with water to remove particles. Wash affected areas with soap and water if available							
<b>INHALATION:</b> Not expected to be an exposure route.							
<b>INGESTION:</b> Not expected to be an exposure source.							
<b>MOST IMPORTANT SYMPTOMS/EFFECTS, ACUTE AND CHRONIC:</b> See Section Eleven for Symptoms/Effects.							
SECTION 5: FIRE AND EXPLOSIVES HAZARDS							
<b>FLASHPOINT:</b> Not Applicable							
<b>EXTINGUISHING MEDIA:</b> Water fog, foam, dry chemical.							
<b>CHEMICAL/COMBUSTION HAZARDS:</b> None known.							
<b>PRECAUTIONS/PERSONAL PROTECTIVE EQUIPMENT:</b> Avoid smoke inhalation. Use appropriate respiratory protection.							
SECTION 6: ACCIDENTAL RELEASE MEASURES							
<b>SPILL OR LEAK PROCEDURES:</b> Not applicable. Product is a solid.							
SECTION 7: HANDLING AND STORAGE							
<b>SAFE HANDLING PROCEDURES:</b> No special requirements.							
<b>SAFE STORAGE:</b> Keep material covered and out of the weather.							
SECTION 8: EXPOSURE CONTROLS/PERSONAL PROTECTION							
<b>OSHA Chemical Name:</b>	<b>PEL</b>	<b>PEL/CEILING</b>	<b>PEL/STEL</b>	<b>SKIN</b>	<b>TLV</b>	<b>TLV/CEILING</b>	<b>ACGIH TLV/STEL</b>
<b>SKIN</b>							
1. None							
<b>ENGINEERING CONTROLS:</b> None required under normal use conditions.							
<b>PERSONAL PROTECTIVE EQUIPMENT:</b> None required under normal conditions of use.							
SECTION 9: PHYSICAL AND CHEMICAL PROPERTIES							

**BOILING POINT:** N/A  
**EVAPORATION RATE:** N/A  
**WEIGHT PER GALLON:** N/A  
**ODOR:** None  
**FLASH POINT:** See Section 5  
**VAPOR PRESSURE:** N/D  
**PARTITION COEFFICIENT:** N/D  
N/D  
**VISCOSITY:** N/D

**VAPOR DENSITY:** N/A  
**pH LEVEL:** N/A  
**PRODUCT APPEARANCE:** Tan Solid  
**ODOR THRESHOLD:** N/D  
**FLAMMABILITY:** N/D  
**RELATIVE DENSITY:** N/D  
**AUTOIGNITION TEMPERATURE:** N/D

**% VOLATILE BY VOLUME:** N/A  
**% VOLATILE BY WEIGHT:** N/A  
**VOC CONTENT:** N/A  
**MELTING/FREEZING POINT:** N/D  
**UEL/LEL:** N/D  
**SOLUBILITY:** N/D  
**DECOMPOSITION TEMPERATURE:**

*N/D: Not Determined*

**SECTION 10: STABILITY/REACTIVITY**

**STABILITY:** Stable. **HAZARDOUS POLYMERIZATION:** Will not occur.  
**CONDITIONS AND MATERIALS TO AVOID:** None recognized.  
**HAZARDOUS DECOMPOSITION PRODUCTS:** None recognized.

**SECTION 11: TOXICOLOGICAL INFORMATION**

**EYE CONTACT:** Direct contact may cause mechanical irritation.  
**SKIN CONTACT:** Direct contact may cause slight mechanical skin irritation.  
**INHALATION:** Not anticipated to be an exposure route.  
**INGESTION:** Not anticipated to be an exposure route.  
**SIGNS AND SYMPTOMS:** Symptoms of eye irritation include tearing, reddening, and swelling. Symptoms of skin irritation include redness and swelling. Gastrointestinal irritation symptoms include nausea, vomiting, and abdominal discomfort.  
**AGGRAVATED MEDICAL CONDITIONS:** None recognized.  
**OTHER HEALTH EFFECTS:** None recognized.

**SECTION 12: ECOLOGICAL INFORMATION**

**ECOTOXICITY:** N/E **DEGRADABILITY:** N/E **BIOACCUMULATIVE POTENTIAL:** N/E  
**SOIL MOBILITY:** N/E **OTHER ADVERSE EFFECTS:** None Recognized

**SECTION 13: WASTE DISPOSAL INFORMATION**

**WASTE DISPOSAL INFORMATION:** Product is classified as a non-hazardous waste.

**SECTION 14: TRANSPORTATION INFORMATION**

**HAZARDOUS/NON-HAZARDOUS MATERIAL:** Not regulated by DOT. **PACKING GROUP:** N/A  
**UN NUMBER:** None. **HAZARD CLASS:** N/A  
**UN PROPER SHIPPING NAME:** N/A  
**ENVIRONMENTAL HAZARDS:** None recognized.  
**BULK TRANSPORTATION INFORMATION:** None.  
**SPECIAL PRECAUTIONS:** None.

**SECTION 15: REGULATORY INFORMATION**

**OTHER REGULATORY CONSIDERATIONS:** None recognized.

**SECTION 16: OTHER INFORMATION**

**PREPARATION DATE:** 12/31/2019  
**PREPARED BY:** Dave Carey

**SAFETY DATA SHEET**

---

---

*The information contained herein is based on the data available to us and is believed to be correct. However, we make no warranty, expressed or implied regarding the accuracy of this data or the results to be obtained from the use thereof. We assume no responsibility for injury from the use of this product described herein.*

---

---



# GUIDE SPECIFICATION FOR SELF-EXPANDING CORK EXPANSION JOINT FILLER

SECTION 03 15 00 – CONCRETE ACCESSORIES/EXPANSION/

CONTRACTION JOINT FILLER

Specifier Notes: This guide specification is written according to the Construction Specifications Institute (CSI) format. The section must be carefully reviewed and edited

Specifier Notes: W. R. MEADOWS® SELF-EXPANDING CORK EXPANSION JOINT is formed and compressed under heat and pressure to permit expansion up to 140% of original thickness after installation, which permits the filler to compensate for concrete shrinkage. Normal humidity conditions after installation activate the self-expanding properties of the cork.

SELF-EXPANDING CORK EXPANSION JOINT is used where high resiliency is needed, such as in sewage plants, floodwalls, spillways, filtration plants, and in numerous commercial and industrial applications. It is especially desirable where a constant friction-fit is required. Recommended and compatible with all known hot-poured and cold-applied joint sealants. Provides effective support to minimize shear stress on the sealant.

## PART 1 GENERAL

1. SECTION INCLUDES
  - A. Application of expansion/contraction joint filler.
2. RELATED SECTIONS

Specifier Notes: Edit the list of related sections as required for the project. List other sections dealing with work directly related to this section.

- A. Section 03 00 00 - Concrete.
- B. Section 07 92 00 – Joint Sealants.
3. REFERENCES
  - A. AASHTO M 153 - Standard Specification for Preformed Sponge Rubber and Cork Expansion Joint Fillers for Concrete Paving and Structural Construction.
  - B. ASTM D 545 – Standard Test Methods for Preformed Expansion Joint Fillers for Concrete Construction (Non-Extruding and Resilient Types).
  - C. ASTM D 1752 - Standard Specification for Preformed Sponge Rubber Cork and Recycled PVC Expansion Joint Fillers for Concrete Paving and Structural Construction.
  - D. Corps of Engineers CRD-C 509 - Standard Specifications for Preformed Sponge Rubber and Cork Expansion Joint Fillers for Concrete Paving and Structural Construction.
  - E. FAA Specification Item P-610-2.7 - Structural Portland Cement Concrete.

F. Federal Specification HH-F-341.

4. SUBMITTALS

A. Comply with Section 01 33 00 - Submittal Procedures.

Project Name 1/16/2017

03 15 00-1

Expansion/Contraction Joint Filler

B. Submit manufacturer's product data and application instructions

5. DELIVERY, STORAGE, AND HANDLING

A. Deliver materials to site in manufacturer's original, unopened containers and packaging, with labels clearly identifying product name and manufacturer.

B. Store materials in a clean, dry area in accordance with manufacturer's instructions.

C. Store cartons in a weatherproof location for periods not longer than six months.

D. Protect materials during handling and application to prevent damage.

PART 2 PRODUCTS

1. MANUFACTURER

A. W. R. MEADOWS, INC., PO Box 338, Hampshire, Illinois 60140-0338.  
(800) 342-5976.(847) 683-4500. Fax (847) 683-4544. Web Site  
www.wrmeadows.com.

2. MATERIALS

A. Performance-Based Specification: Expansion joint filler composed of granulated cork particles, resin-bonded into board form, compressed and dehydrated under heat and pressure, that will expand up to 140% of the original thickness after installation due to the re-absorption of moisture. Joint filler shall conform to the following standards and have the following requirements:

1. ASTM D 1752, Type III.
2. AASHTO M 213, Type II.
3. FAA Spec Item P-610-2.7.
4. COE CRD-C-509, Type II.
5. Federal Specification HH-F-341 F, Type II, Class B.
6. ASTM D 545
  - a. Density Minimum: 16.0 lb./ft.<sup>3</sup> (256 kg/m<sup>3</sup>)
  - b. Load to Compress to 50% original thickness: 50 – 1500 psi (0.34 – 10.33MPa).
  - c. Recovery Minimum: 90%.

Specifier Notes: Specify the thickness of the expansion-contraction joint filler according to project requirements.

7. Thickness: [1/2"] [3/4"] [1"] ([13 mm] [19 mm] [25 mm]).

B. Proprietary-Based Specification: SELF-EXPANDING CORK EXPANSION JOINT Filler by W. R. MEADOWS.

PART 3 EXECUTION

1. EXAMINATION

- A. Examine areas to receive expansion/contraction joint filler. Notify architect or engineer if areas are not acceptable. Do not begin application until unacceptable conditions have been corrected.

2. APPLICATION

- A. Install expansion-contraction joint filler in accordance with manufacturer's instructions.

Project Name 1/16/2017

03 15 00-1

Expansion/Contraction Joint Filler

- B. Position joint filler against walls, at interrupting objects or columns, and against abutting structures before concrete placement.
- C. Install joint filler 1/2" (6 mm) below concrete finish level.
- D. Prior to sealing, slide expansion joint cap over the expansion joint.
- E. Place concrete and allow to cure.
- F. Insert screwdriver through the top of expansion joint cap, pull free and discard.
- G. Seal with suitable joint sealant.

4. PROTECTION

- A. Protect joint sealant from jobsite abuse prior to joint sealant application.

END OF SECTION

Project Name 1/16/2017

03 15 00-1

Expansion/Contraction Joint Filler



Installation Instructions – Masonry, Wood, Swimming Pool Decks or Concrete Joints

1. Surface Preparation - Prior to application of REZI-WELD LV primer, joint surfaces must be structurally sound, clean, dry, and free of oil, grease, dirt, and loose particles.

2. Mixing - Components are pre-measured to exact quantities; mix all material in both containers. Pour part A into part B and mix thoroughly with a clean wooden or metal paddle for four minutes. Scrape container sides and bottom for complete integration. After mixing, work life of a quart unit is approximately 30 minutes at 70° F (21.1°).

3. Application Method - Apply REZI-WELD LV to properly prepared joint surfaces by brush, depositing a light, continuous film. Depending on the porosity of the surface and joint dimensions, one quart (.95 L) of REZI-WELD LV will be sufficient for 5 – 7 gallons (18.9 – 26.5 L) of sealant. Normally one coat is sufficient; however, two coats should be applied to porous surfaces. Do not over-apply. Use caution when applying in joints with backer rods. Over-application onto backer rod can result in three-sided bonding.

Sealant can be applied as soon as the primer is applied. For optimal adhesion, primer should be tacky to the touch when applying the joint sealant. This window (time the REZI-WELD LV is tacky) can last up to two hours at 75° F (23° C). If REZI-WELD LV becomes tack-free, prior to application of the sealant, application of the joint sealant can still take place within 12 hours of the initial application of the primer at 75° F (23° C).

**DECK-O-SEAL** | P.O. Box 397 |  
HAMPSHIRE, IL 60140-0338  
Phone: 800-542-7665 | Fax: 847-214-2268

| [www.deckoseal.com](http://www.deckoseal.com)

If the primer is no longer tacky and is within the initial 12 hours wipe the primed area with a solvent, such as xylene and/or toluene, just prior to applying the sealant. If 12 hours has elapsed since initial application of the primer, reapply the properly mixed primer. The open time will decrease as the air/substrate temperature increases and conversely will increase as the air/substrate temperature decreases.

Applications in direct sun will decrease the open time. REZI-WELD LV primer is non-staining amber color, and should not be applied to a exposed surfaces, as discoloration may become apparent. Joint edges can be taped to avoid application of primer on exposed edges.

4. Clean tools and equipment with xylene or toluene and remove masking tape before the sealant starts to set. Please read and understand the safety data sheet and all local, state and federal laws regarding the use of xylene or toluene or any other solvents.

5. PRECAUTIONS - DO NOT DILUTE. Mix complete units only. Not recommended for use when the concrete and air temperature is below 40° F (4° C) or will drop below 40° F (4° C) within 24 hours. Do not use to seal cracks under hydrostatic pressure. Do not warm epoxy over direct heat. Safety glasses and chemical-resistant gloves should be worn at all times when mixing or applying the primer. Apply in a well-ventilated area. Keep out of the reach of children. Unused epoxy will generate excessive heat, especially in large quantities. Unused epoxy should be mixed with dry sand in the container to help lower heat. Refer to safety data sheet of the DECK-O-SEAL product and REZI-WELD LV for complete health and safety information



# PRODUCT DATA

MasterFormat:07 92 13  
13 11 00

No. 785

JUNE 2014  
(Supersedes February 2009)

## DECK-O-SEAL GUN GRADE

Two-Part, Gun Grade Joint Sealant

### DESCRIPTION

DECK-O-SEAL GUN GRADE is a two-component, non-sag, non-flowing, polysulfide-based sealing compound. It is a non-staining sealant that cures to a firm, flexible, tear-resistant rubber. DECK-O-SEAL GUN GRADE is highly resilient and has excellent recovery characteristics, even after extended periods of compression or elongation. It has outstanding resistance to most chemicals, to all weather conditions, aging, and shrinkage. For on-the-job use, DECK-O-SEAL GUN GRADE is supplied in pre-measured kits containing the base compound and a separate container of setting agent, with enough room in the base container for blending both components.

### USES

DECK-O-SEAL GUN GRADE is a premium quality, flexible sealing compound for use in applications where short turn-around time is a requirement, such as pool bottom and sidewall repairs and areas subject to pedestrian and vehicular traffic.

DECK-O-SEAL GUN GRADE can be used for general purpose caulking of joints and seams (both above and below water), glazing, weatherproofing, exterior curtain wall sealing, and interior/exterior expansion joint sealing. All submerged applications must be primed with REZI-WELD LV from W.

R. MEADOWS.

### FEATURES/BENEFITS

- Non-staining sealant cures to a firm, flexible, tear-resistant rubber.
- Highly resilient with excellent recovery characteristics.
- Outstanding resistance to most chemicals, all weather conditions, aging, and shrinkage.
- Ideal for short turn-around time applications, i.e. pool bottoms, sidewall repairs, and high pedestrian and vehicular traffic.
- Used for general purpose caulking, glazing, weatherproofing, and curtain wall and joint sealing.
- Supplied in unitized, pre-measured packaging (base and setting agent), ready for instant blending.

### PACKAGING

96 Oz. (2.8 Liter) Kits  
Standard colors: Dura-White, Stone Gray, Desert Tan, Jet Black and Redwood available upon special order.  
1.75 Gallon (6.6 Liter) Cans  
Available only in Stone Gray

### COVERAGE

Joint Depth	Joint Width						
	¼" (6.4 mm)	3/8" (9.5 mm)	1/2" (12.7 mm)	5/8" (15.9 mm)	3/4" (19.1 mm)	7/8" (22.2 mm)	1" (25.4 mm)
1/4" (6.4 mm)	231 (70.4)	154 (46.9)	106 (32.3)	92 (28)	77 (23.5)	66 (20.1)	58 (17.7)
3/8" (9.5 mm)		102 (31.1)	77 (23.5)	62 (18.9)	51 (15.5)	44 (13.4)	38 (11.5)
1/2" (12.7 mm)			58 (17.7)	46 (14)	38 (11.5)	33 (10)	29 (8.8)
5/8" (15.9 mm)				37 (11.2)	31 (9.4)	26 (7.9)	23 (7)
3/4" (19.1 mm)					26 (7.9)	22 (6.7)	19 (5.8)
7/8" (22.2 mm)						19 (5.8)	17 (5.1)
1" (25.4 mm)							14 (4.2)

Approximate number of lineal feet (lineal meters) that can be sealed with 96-ounce DECK-O-SEAL kit.

### SHELF LIFE

One year from date of manufacture. Store unopened product in a cool, dry place [under 80° F) (27° C)].

### SPECIFICATIONS

- Federal Specification A-A-1556A, Type M, Grade NS, Class 25, Use T
- ASTM D-506, Type II, Classes A & B
- ASTM C 920, Type M, Grade NS, Class 25, Use T (Except for application, life requirement)



### TECHNICAL DATA

Consistency	Thixotropic paste
-------------	-------------------

Application Life [77° F (25° C), 50% RH]	Approx. 1 hour
Tack Free Time [77° F (25° C), 50% RH]	4 hours maximum
Linear Shrinkage	Negligible

**A DIVISION OF W. R. MEADOWS**

[www.deckoseal.com](http://www.deckoseal.com)

P.O. BOX 397 • HAMPSHIRE, IL 60140 • PHONE: 800-542-POOL (7665) • FAX: 847-214-2268

PAGE 2 ... DECK-O-SEAL GUN GRADE #785 ... JUNE 2014

Volume Shrinkage	Negligible
Shore Hardness	Shore A 20±5
Tensile Strength	125 to 250 psi (862.5 to 1725 KPa)
Elongation	400%
Peel Adhesion (Per ASTM C 794) Plate Glass, Aluminum, 20lb./in. Min. (357 g/ mm) Concrete	20 lb./in. min. (357 g/mm)
Application Temperature Range	40° to 122° F (4° to 50° C)
VOC Content	0 g/L

sealant *depth* be less than 1/4" (6.4 mm) or exceed 1/2" (12.7 mm). DECK- O-SEAL GUN GRADE should NOT be used in joints less than 1/4" (6.4 mm) wide. **Mixing ...** DECK-O-SEAL GUN GRADE is supplied in pre-measured kits with a ratio of setting agent to base, which must be maintained. Store and mix in a cool, shaded area. Do not mix until ready to use. (Product cannot be re-sealed for future use.) De-rim both cans with a can opener. Pour the setting agent into the base and mix slowly. To aid in proper mixing, scrape material from the sides and bottom of the container until a uniform color is obtained. **Continue for a recommended 10 minutes, minimum.** A slow- speed drill can be used. Care must be taken to ensure that the entire setting agent is thoroughly blended with the base component. Avoid trapping air in the sealant.

**Application Method ...** At 77° F (25° C) and 30% relative humidity,

All technical data is typical information, but may vary due to test methods, conditions and operators.

**APPLICATION**

Follow these instructions carefully for maximum effectiveness. BE SURE TO WEAR PROTECTIVE SAFETY GLASSES AND CHEMICAL-RESISTANT GLOVES.

**Surface Preparation ...** Remove foreign substances, incompressibles, and free water from joint opening. For proper adhesion, joints must be clean and dry. Dust, dirt, and laitance should be removed prior to application. Concrete should be completely cured and free from all foreign materials and contamination from curing agents. (Industry accepted standard for curing concrete is 28 days.) To maintain cleanliness around the joint to be sealed, apply masking tape 2" wide to the surfaces adjoining both sides of the joint before REZI-WELD LV and/or DECK-O-SEAL GUN GRADE are applied.

**Priming...** DECK-O-SEAL GUN GRADE adheres well to unprimed concrete; however, REZI-WELD<sub>™</sub> LV from W. R.

MEADOWS is recommended for optimum adhesion. REZI-WELD LV is required for all joints submerged underwater and/or joints over 1" (25.4 mm) in width. Apply DECK-O-SEAL GUN GRADE while the REZI-WELD LV primer is still tacky. The open time (time to apply the DECK-O- SEAL GUN GRADE following application of the REZI-WELD LV) is up to two hours at 75° F (23° C). If REZI-WELD LV becomes tack-free prior to application of DECK-O-SEAL GUN GRADE, reapply the properly mixed primer. The open time will decrease as the air/substrate temperature increases and conversely will increase as the air/substrate temperature decreases. Applications in direct sun will decrease the open time. For detailed mixing and installation instructions for REZI-WELD LV, please reference product data sheet at [www.wrmeadows.com](http://www.wrmeadows.com).

**Joint Sizes ...** Proper joint design practices and application techniques must be followed for successful performance. DECK- O-FOAM<sub>®</sub> or KOOL-ROD<sub>™</sub> from W. R. MEADOWS may be used as a joint backing material to control sealant depth and provide proper joint configuration. For larger joints, use a non- asphalt joint filler, such as CORK EXPANSION JOINT from W.

R. MEADOWS, in the joint before sealing. A 2:1 width-to-depth ratio should be maintained. However, in no case should joint

application life is approximately one hour. Apply thoroughly blended material with a hand- or air-operated caulking gun, putty knife, or trowel. Tool sealant beads with tools wetted with clean water. Handgun application is most effective at temperatures of 60° F (15.6°) or higher. Air-operated equipment is effective at temperatures as low as 40° F (4.4°). DECK-O-SEAL GUN GRADE will set firm and rubbery within 24 hours at 77° F (25° C). At lower temperatures, curing time may take longer.

**Cleanup ...** Application equipment should be cleaned promptly with xylene or toluene. Joints may be taped for neatness and to minimize any cleaning requirements. Avoid contact with skin. Wash with soap and water immediately if contact should occur. Refer to Safety Data Sheet complete health and safety information.

**Maintenance ...** If DECK-O-SEAL GUN GRADE is damaged, and the joint has not been contaminated, it can be repaired by cutting out the damaged portion and re-sealing it with DECK-O-SEAL GUN GRADE.

### **PRECAUTIONS**

DECK-O-SEAL GUN GRADE is not compatible with asphalt and cannot be used in asphalt concrete pavement or

with asphalt-impregnated expansion joint fillers. Note: Do not apply paint over any surfaces sealed with DECK- O-SEAL GUN GRADE. It is strongly recommended that joints under the water line be installed by a professional contractor trained in joint sealing application techniques. Consult with an engineer for proper joint design or waterproofing detail. Homeowners should not attempt these installations. If chlorine granules are used, they must be pre-dissolved before adding to the pool. Due to issues in maintenance, water chemistry, and/or the type of sanitizer used, settlements and growths can attach to the product. This is usually a cosmetic issue only and does not affect the integrity of the product. It is recommended that a NSPF-certified pool operator or like professional maintains the pool and water according to the bather load at least weekly in accordance to APSP guidelines and the Langelier Saturation Index.

### **LEED INFORMATION**

May help contribute to LEED credits:

- MRc9: Construction and Demolition Waste Management
- EQc2: Low-Emitting Materials [For Healthcare and Schools (exterior-applied products) ONLY]

**For most current data sheet, further LEED information, and SDS, visit**

[www.deckoseal.com](http://www.deckoseal.com).

### **LIMITED WARRANTY**

**“DECK-O-SEAL®, A Division of W. R. MEADOWS, INC., warrants at the time and place we make shipment, our material will be of good quality and will conform with our published specifications in force on the date of acceptance of the order.” Read complete warranty. Copy furnished upon request.**

### **Disclaimer**

**The information contained herein is included for illustrative purposes only, and to the best of our knowledge, is accurate and reliable. DECK-O-SEAL cannot however under any circumstances make any guarantee of results or assume any obligation or liability in connection with the use of this information. As DECK-O-SEAL has no control over the use to which others may put its product, it is recommended that the products be tested to determine if suitable for specific application and/or our information is valid in a particular circumstance. Responsibility remains with the architect or engineer, contractor and owner for the design, application and proper installation of each product. Specifier and user shall determine the suitability of products for specific application and assume all responsibilities in connection therewith.**





# SAFETY DATA SHEET

SECTION 1: PRODUCT AND COMPANY IDENTIFICATION						
<b>Product:</b>	<b>DECK-O-SEAL® Base (PG, GG, 125)</b>			<b>Part Number: 4701100</b>		
<b>Manufacturer:</b>	<b>W. R. MEADOWS, INC.</b>			<b>Address: 300 Industrial Drive</b>		
	Hampshire, Illinois 60140					
<b>Telephone:</b>	(847) 214-2100		In case of emergency, dial (800) 424-9300 (CHEMTREC)			
<b>Revision Date:</b>	4/15/2020					
<b>Product Use:</b>	Two Component Joint Sealant					
SECTION 2: HAZARDS IDENTIFICATION/EXPOSURE LIMITS						
<b>HMIS</b>			<b>HAZARD STATEMENTS</b>			
Health	1	<b>WARNING!</b>				
Flammability	1	May cause skin/eye irritation.				
Reactivity	0	<b>PRECAUTIONARY STATEMENTS</b>				
Personal Protection		Avoid direct contact.				
Avoid breathing aerosols/sprays.						
SECTION 3: HAZARDS COMPONENTS						
<b>Chemical Name:</b>	<b>CAS Number</b>	<b>% by Weight</b>	<b>SARA 313</b>	<b>Vapor Pressure (mm Hg@20°C)</b>	<b>LEL (@25°C)</b>	<i>N/A = Not Applicable N/E = Not Established</i>
1. Titanium Dioxide	13463-67-7	1-5	No	N/E	N/E	
<i>This product contains limestone. Limestone contains crystalline silica as a naturally occurring component. Exposure to silica is not expected to occur as the product is supplied as a solution. If product is dry/abraded, appropriate protective measures should be taken to control exposure to airborne silica exposures.</i>						
Under the reporting requirements of Section 313 of Title III of the Superfund Amendments and Reauthorization Act of 1966 (SARA) and 40 CFR Part 372, chemicals listed on the 313 List (40 CFR Part 373.65) are identified under the heading "SARA 313."						
SECTION 4: EMERGENCY AND FIRST AID PROCEDURES						

**EYE CONTACT:** Move victim from exposure source. Flush eyes with water for fifteen (15) minutes. If symptoms persist, seek medical attention.  
**SKIN CONTACT:** Remove contaminated shoes/clothing. Wash affected areas with mild soap and water. If symptoms persist, seek medical attention.  
**INHALATION:** Move victim from exposure source and treat symptoms. If symptoms persist, seek immediate medical attention. Do not induce vomiting. If vomiting spontaneously occurs, keep the victim's head below the hips to prevent lung aspiration.  
**MOST IMPORTANT SYMPTOMS/EFFECTS, ACUTE AND CHRONIC:** See Section Eleven for Symptoms/Effects.

**SECTION 5: FIRE AND EXPLOSIVES HAZARDS**

**FLASHPOINT:** > 210 °F  
**EXTINGUISHING MEDIA:** Water fog, foam, dry chemical, and carbon dioxide.  
**CHEMICAL/COMBUSTION HAZARDS:** Carbon monoxide, carbon dioxide and incomplete combustion products may be emitted.  
**PRECAUTIONS/PERSONAL PROTECTIVE EQUIPMENT:** Use of full fire protection ensemble with SCBA is recommended.

**SECTION 6: ACCIDENTAL RELEASE MEASURES**

**SPILL OR LEAK PROCEDURES:** Evacuate area of unprotected personnel. Dike/contain spilled material. Take up with an appropriate absorbent and place in sealed/marked containers for proper disposal.

**SECTION 7: HANDLING AND STORAGE**

**SAFE HANDLING PROCEDURES:** Avoid direct contact.  
**SAFE STORAGE:** Keep containers closed when not in use. Store in cool/dry location.

**SECTION 8: EXPOSURE CONTROLS/PERSONAL PROTECTION**

OSHA Chemical Name:	PEL	PEL/CEILING	PEL/STEL	SKIN	TWA	ACGIH		SKIN
						TLV/CEILING	TLV/STEL	
3. Titanium Dioxide*	N/A	N/A	N/A	N/A	N/A	N/A	N/A	N/A

\*Titanium dioxide exposure limits not provided as materials are in suspension.



**SAFETY DATA SHEET**

**SECTION 1: PRODUCT AND COMPANY IDENTIFICATION**

**Product:** DECK-O-SEAL® Base (PG, GG, 125) **Part Number:**  
**4701100 Manufacturer:** W. R. MEADOWS, INC. **Address:** 300  
 Industrial Drive  
 Hampshire, Illinois 60140  
**Telephone:** (847) 214-2100 **In case of emergency, dial (800) 424-9300**  
 (CHEMTREC)  
**Revision Date:** 4/15/2020  
**Product Use:** Two Component Joint Sealant

**SECTION 2: HAZARDS IDENTIFICATION/EXPOSURE LIMITS**

HMIS	HAZARD STATEMENTS
Health   1	<b>WARNING!</b>
Flammability   1	May cause skin/eye irritation.
Reactivity   0	<b>PRECAUTIONARY STATEMENTS</b>
Personal Protection	Avoid direct contact.

Avoid breathing aerosols/sprays.

**SECTION 3: HAZARDS COMPONENTS**

<b>Chemical Name:</b>	<b>CAS Number</b>	<b>% by Weight</b>	<b>SARA 313</b>	<b>Vapor Pressure (mm Hg@20°C)</b>	<b>LEL (@25°C)</b>	<i>N/A = Not Applicable N/E = Not Established</i>		
1. Titanium Dioxide	13463-67-7	1-5	No	N/E	N/E			
<p><i>This product contains limestone. Limestone contains crystalline silica as a naturally occurring component. Exposure to silica is not expected to occur as the product is supplied as a solution. If product is dry/abraded, appropriate protective measures should be taken to control exposure to airborne silica exposures.</i></p> <p>Under the reporting requirements of Section 313 of Title III of the Superfund Amendments and Reauthorization Act of 1966 (SARA) and 40 CFR Part 372, chemicals listed on the 313 List (40 CFR Part 373.65) are identified under the heading "SARA 313."</p>								
<b>SECTION 4: EMERGENCY AND FIRST AID PROCEDURES</b>								
<p><b>EYE CONTACT:</b> Move victim from exposure source. Flush eyes with water for fifteen (15) minutes. If symptoms persist, seek medical attention.</p> <p><b>SKIN CONTACT:</b> Remove contaminated shoes/clothing. Wash affected areas with mild soap and water. If symptoms persist, seek medical attention.</p> <p><b>INHALATION:</b> Move victim from exposure source and treat symptoms. If symptoms persist, seek immediate medical attention. Do not induce vomiting. If vomiting spontaneously occurs, keep the victim's head below the hips to prevent lung aspiration.</p> <p><b>MOST IMPORTANT SYMPTOMS/EFFECTS, ACUTE AND CHRONIC:</b> See Section Eleven for Symptoms/Effects.</p>								
<b>SECTION 5: FIRE AND EXPLOSIVES HAZARDS</b>								
<p><b>FLASHPOINT:</b> &gt; 210 °F</p> <p><b>EXTINGUISHING MEDIA:</b> Water fog, foam, dry chemical, and carbon dioxide.</p> <p><b>CHEMICAL/COMBUSTION HAZARDS:</b> Carbon monoxide, carbon dioxide and incomplete combustion products may be emitted.</p> <p><b>PRECAUTIONS/PERSONAL PROTECTIVE EQUIPMENT:</b> Use of full fire protection ensemble with SCBA is recommended.</p>								
<b>SECTION 6: ACCIDENTAL RELEASE MEASURES</b>								
<p><b>SPILL OR LEAK PROCEDURES:</b> Evacuate area of unprotected personnel. Dike/contain spilled material. Take up with an appropriate absorbent and place in sealed/marked containers for proper disposal.</p>								
<b>SECTION 7: HANDLING AND STORAGE</b>								
<p><b>SAFE HANDLING PROCEDURES:</b> Avoid direct contact.</p> <p><b>SAFE STORAGE:</b> Keep containers closed when not in use. Store in cool/dry location.</p>								
<b>SECTION 8: EXPOSURE CONTROLS/PERSONAL PROTECTION</b>								
<b>OSHA Chemical Name:</b>	<b>PEL</b>	<b>PEL/CEILING</b>	<b>PEL/STEL</b>	<b>SKIN</b>	<b>TWA</b>	<b>TLV/CEILING</b>	<b>ACGIH TLV/STEL</b>	<b>SKIN</b>
3. Titanium Dioxide*	N/A	N/A	N/A	N/A	N/A	N/A	N/A	N/A N/A
*Titanium dioxide exposure limits not provided as materials are in suspension.								



Date of Preparation: 4/15/20  
4701100

Page 3 of 3

---

---

**SAFETY DATA SHEET**

---

---

*The information contained herein is based on the data available to us and is believed to be correct. However, we make no warranty, expressed or implied, regarding the accuracy of this data or the results to be obtained from the use thereof. We assume no responsibility for injury from the use of this product described herein.*

---

---



# SAFETY DATA SHEET

SECTION 1: PRODUCT AND COMPANY IDENTIFICATION					
<b>Product:</b>	<b>DECK-O-SEAL® GUN GRADE Setting Agent</b>	<b>Part Number: 4702000</b>			
<b>Manufacturer:</b>	<b>W. R. MEADOWS, INC.</b>	<b>Address:</b> 300 Industrial Drive Hampshire, Illinois 60140			
<b>Telephone:</b>	(847) 214-2100				
<b>Revision Date:</b>	4/15/2020 (CHEMTREC)	In case of emergency, dial (800) 424-9300			
<b>Product Use:</b>	Two Component Joint Sealant				
SECTION 2: HAZARDS IDENTIFICATION/EXPOSURE LIMITS					
	<b>HMIS</b>	<b>HAZARD STATEMENTS</b>			
Health	1	<b>WARNING!</b>			
Flammability	1	May cause skin/eye irritation.			
Reactivity	0	May cause an allergic skin reaction.			
Personal Protection		<b>PRECAUTIONARY STATEMENTS</b>			
		Avoid direct contact.			
		Avoid breathing aerosols/sprays.			
SECTION 3: HAZARDS COMPONENTS					
<b>% by</b>	<b>SARA</b>	<b>Vapor Pressure</b>			
<b>LEL Chemical Name:</b>	<b>CAS Number</b>	<b>Weight</b>	<b>313</b>	<b>(mm Hg@20°C)</b>	
<b>(@25°C)</b>					
1. Epoxy Resin	25068-38-6	5-10	No	N/E	N/E
2. Dimethylbenzyl Hydroperoxide	80-15-9	5-10	Yes	2	N/E
3. Titanium Dioxide	13463-67-7	0-28	No	N/E	N/E
<i>N/A = Not Applicable</i>			<i>N/E = Not Established</i>		
This product contains limestone. Limestone contains crystalline silica as a naturally occurring component. Exposure to silica is not expected to occur as the product is supplied as a solution. If product is dry/abraded appropriate protective measures should be taken to control exposure to airborne silica.					
Under the reporting requirements of Section 313 of Title III of the Superfund Amendments and Reauthorization Act of 1966 (SARA) and 40 CFR Part 372, chemicals listed on the 313 List (40 CFR Part 373.65) are identified under the heading "SARA 313."					
SECTION 4: EMERGENCY AND FIRST AID PROCEDURES					
<b>EYE CONTACT:</b> Move victim from exposure source. Flush eyes with water for fifteen minutes. If symptoms persist, seek medical attention.					
<b>SKIN CONTACT:</b> Remove contaminated shoes/clothing. Wash affected areas with mild soap and water. If symptoms persist, seek medical attention.					
<b>INHALATION:</b> Move victim from exposure source and treat symptoms. If symptoms persist, seek medical attention.					
<b>INGESTION:</b> Seek immediate medical attention. Do not induce vomiting. If vomiting spontaneously occurs, keep the victim's head below the hips to prevent lung aspiration.					
<b>MOST IMPORTANT SYMPTOMS/EFFECTS, ACUTE AND CHRONIC:</b> See Section Eleven for Symptoms/Effects.					
SECTION 5: FIRE AND EXPLOSIVES HAZARDS					
<b>FLASHPOINT:</b> > 210 °F					
<b>EXTINGUISHING MEDIA:</b> Water fog, foam, dry chemical, and carbon dioxide.					
<b>CHEMICAL/COMBUSTION HAZARDS:</b> Carbon monoxide, carbon dioxide, and incomplete combustion products may be emitted.					
<b>PRECAUTIONS/PERSONAL PROTECTIVE EQUIPMENT:</b> Use of full fire protection ensemble with SCBA is recommended.					
SECTION 6: ACCIDENTAL RELEASE MEASURES					

**SPILL OR LEAK PROCEDURES:** Evacuate area of unprotected personnel. Dike/contain spilled material. Take up with an appropriate absorbent and place in sealed/marked containers for proper disposal.

**SECTION 7: HANDLING AND STORAGE**

**SAFE HANDLING PROCEDURES:** Avoid direct contact.

**SAFE STORAGE:** Keep containers closed when not in use. Store in cool/dry location.



## SECTION 8: EXPOSURE CONTROLS/PERSONAL PROTECTION

OSHA <u>Chemical Name:</u>	ACGIH							<u>SKIN</u>
	<u>PEL</u>	<u>PEL/CEILING</u>	<u>PEL/STEL</u>	<u>SKIN</u>	<u>TWA</u>	<u>TLV/CEILING</u>	<u>TLV/STEL</u>	
1. Epoxy Resin N/E	N/E	N/E	N/E	N/E	N/E	N/E	N/E	
2. Dimethyl Benzyl Hydroperoxide	N/E	N/E	N/E	N/E	N/E	N/E	N/E	N/E
3. Titanium Dioxide* N/A	N/A	N/A	N/A	N/A	N/A	N/A	N/A	

\*Titanium dioxide exposure limits not provided as materials are in suspension.

**ENGINEERING CONTROLS:** None normally required under normal use conditions.

**PERSONAL PROTECTIVE EQUIPMENT:** Safety glasses, chemical-resistant gloves.

## SECTION 9: PHYSICAL AND CHEMICAL PROPERTIES

<b>BOILING POINT:</b> 250 °F	<b>VAPOR DENSITY:</b> >1 (Air=1)	<b>% VOLATILE BY VOLUME:</b> Not
Applicable <b>EVAPORATION RATE:</b> <1 (Ether=1)	<b>pH LEVEL:</b> N/A	<b>% VOLATILE BY WEIGHT:</b> Not Applicable
<b>WEIGHT PER GALLON:</b> 15.14	<b>PRODUCT APPEARANCE:</b> Heavy Liquid	<b>VOC CONTENT:</b> 0 g/L
<b>ODOR:</b> Mild Organic	<b>ODOR THRESHOLD:</b> N/D	<b>MELTING/FREEZING POINT:</b> N/D
<b>FLASH POINT:</b> See Section 5	<b>FLAMMABILITY:</b> N/D	<b>UEL/LEL:</b> N/D
<b>VAPOR PRESSURE:</b> N/D	<b>RELATIVE DENSITY:</b> N/D	<b>SOLUBILITY:</b> N/D
<b>PARTITION COEFFICIENT:</b> N/D	<b>AUTOIGNITION TEMPERATURE:</b> N/D	<b>DECOMPOSITION TEMPERATURE:</b> N/D
<b>VISCOSITY:</b> N/D		<i>N/D: Not Determined</i>

## SECTION 10: STABILITY/REACTIVITY

**STABILITY:** Stable. **HAZARDOUS POLYMERIZATION:** Will not occur.  
**CONDITIONS AND MATERIALS TO AVOID:** Oxidizing materials, strong acids, lead, copper, and their alloys, zinc, amines, polyamines, and polyamides under uncontrolled conditions.  
**HAZARDOUS DECOMPOSITION PRODUCTS:** Carbon monoxide, carbon dioxide, and incomplete combustion products.

## SECTION 11: TOXICOLOGICAL INFORMATION

**EYE CONTACT:** Direct contact may cause mild to moderate irritation.  
**SKIN CONTACT:** Direct contact may result in mild to moderate irritation. May cause a skin sensitization reaction in susceptible individuals. Skin sensitization may be temporary or permanent. Once an individual is diagnosed as sensitized, no further exposures can be permitted.  
**INHALATION:** Not expected to be an exposure route under normal use conditions.  
**INGESTION:** Not expected to be an exposure route under normal use conditions.  
**SIGNS AND SYMPTOMS:** Symptoms of eye irritation include pain, tearing, redness, and swelling. Symptoms of skin irritation include reddening, swelling, rash, and redness. Symptoms of respiratory irritation include runny nose, chest discomfort, shortness of breath, and reduced lung function. Symptoms of gastrointestinal irritation include sore throat, abdominal pain, nausea, vomiting, and diarrhea. Skin sensitization includes allergic dermatitis exhibited by rash, itching, hives, and swelling of extremities.  
**AGGRAVATED MEDICAL CONDITIONS:** Pre-existing skin, eye, and respiratory disorders may be aggravated by exposure to this product.  
**OTHER HEALTH EFFECTS:** None recognized.

## SECTION 12: ECOLOGICAL INFORMATION

**ECOTOXICITY:** Not Established **DEGRADABILITY:** N/E **BIOACCUMULATIVE POTENTIAL:** N/E  
**SOIL MOBILITY:** N/E **OTHER ADVERSE EFFECTS:** N/E

## SECTION 13: WASTE DISPOSAL INFORMATION

**WASTE DISPOSAL INFORMATION:** Non-hazardous material for waste disposal purposes. Material mixed and set up can be landfill disposed.

## SECTION 14: TRANSPORTATION INFORMATION



**HAZARDOUS/NON-HAZARDOUS MATERIAL:** Non-hazardous.  
**UN NUMBER:** None.                   **HAZARD CLASS:** None.                   **PACKING GROUP:** None.  
**UN PROPER SHIPPING NAME:** Not regulated.  
**ENVIRONMENTAL HAZARDS:** Not determined.  
**BULK TRANSPORTATION INFORMATION:** Not applicable; product is not shipped in bulk.  
**SPECIAL PRECAUTIONS:**     None recognized.

## **SAFETY DATA SHEET**

## SAFETY DATA SHEET

<b>Date of Preparation:</b> 4/15/20 4702000	<b>Page 3 of 3</b>
<b>SECTION 15: REGULATORY INFORMATION</b>	
<b>OTHER REGULATORY CONSIDERATIONS:</b> None.	
<b>SECTION 16: OTHER INFORMATION</b>	
<b>PREPARATION DATE:</b>	4/15/2020
<b>PREPARED BY:</b>	Dave Carey

---

---

*The information contained herein is based on the data available to us and is believed to be correct. However, we make no warranty, expressed or implied, regarding the accuracy of this data or the results to be obtained from the use thereof. We assume no responsibility for injury from the use of this product described herein.*

## EXHIBIT C

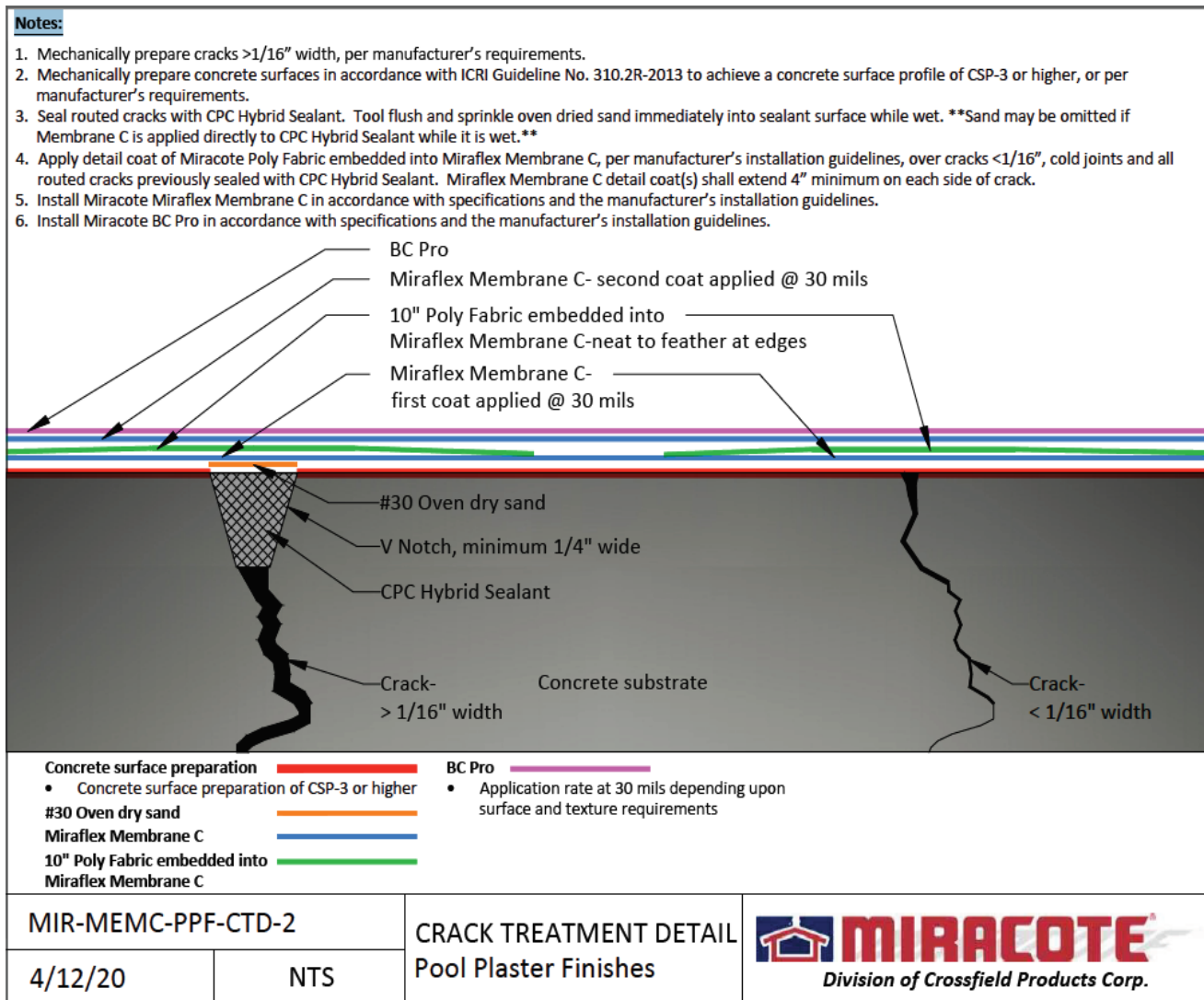

**Notes:**

1. Chip existing substrate around pipe.
2. PVC pipe surface preparation - PVC must be clean and abraded prior to sealant.
3. Fill irregularities in void with Mirapatch WP or Mirapatch Mortar Bed 2000 as needed.
4. Cant bead of CPC Hybrid Sealant.
5. #30 oven dry sand. \*\*Sand may be omitted if Membrane C is applied directly to CPC Hybrid Sealant while
6. Miraflex Membrane C - First coat applied at 30 mils.
7. 10" Poly Fabric embedded into Miraflex Membrane C - cut a "cross" in the middle of the Poly Fabric to place over pipe.
8. Miraflex Membrane C - Second coat applied at 30 mils.

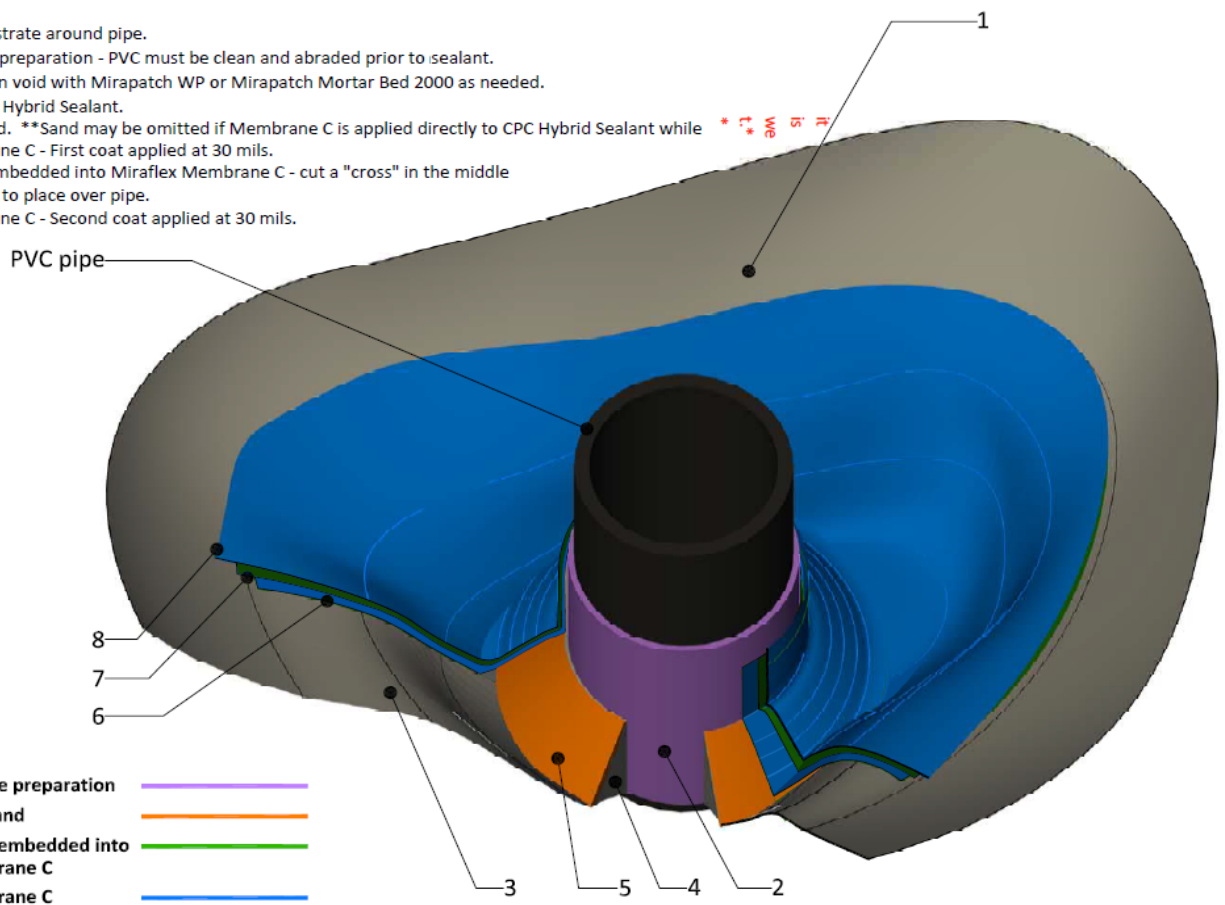

MIR-MEMC-PD1

4/12/20

NTS

PIPE DETAIL  
Miraflex Membrane C



**Notes:**

1. Mechanically prepare concrete surfaces in accordance with ICRI Guideline No. 310.2R-2013 to achieve a concrete surface profile of CSP-3 or higher, or per manufacturer's requirements.
2. Install cant bead of CPC Hybrid Sealant at vertical transition. Tool flush/sprinkle oven dried sand immediately into sealant surface while wet. \*\*Sand may be omitted if Membrane C is applied directly to CPC Hybrid Sealant while it is wet.\*\*
3. Install Miracote Miraflex Membrane C in accordance with specifications and manufacturer's installation guidelines.

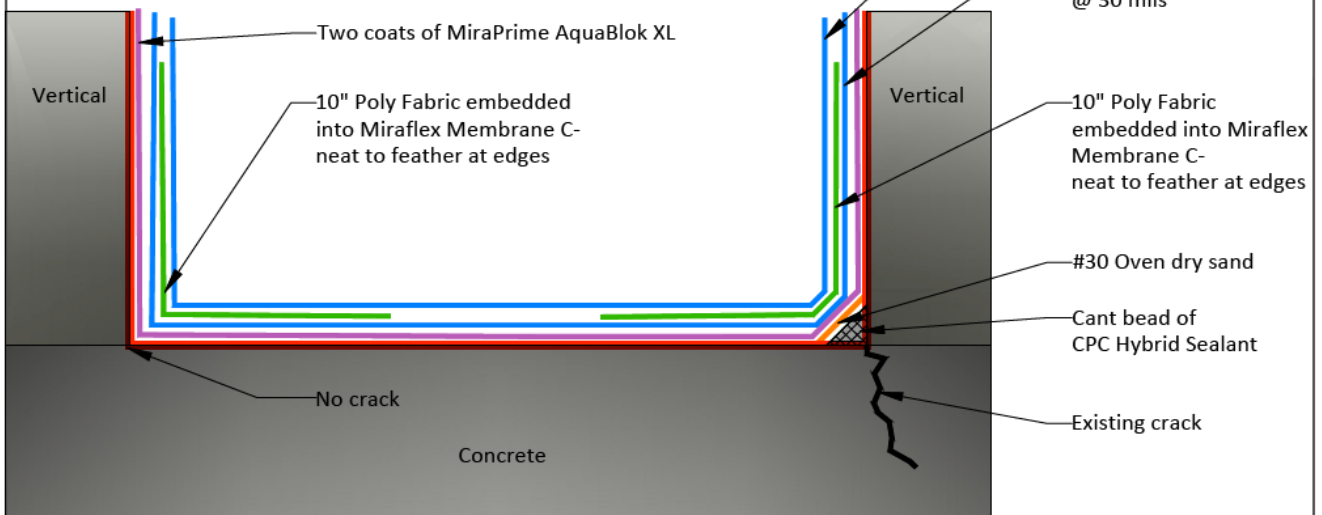

- Concrete surface preparation** █
- Concrete surface preparation of CSP-3 or higher
- MiraPrime AquaBlok XL** █
- #30 Oven dry sand** █
- Miraflex Membrane C** █
- 10" Poly Fabric embedded into Miraflex Membrane C** █

MIR-MEMC-CPD1		CHANGE IN PLANE DETAIL Miraflex Membrane C	 Division of Crossfield Products Corp.
4/12/20	NTS		

**Notes:**

1. Mechanically prepare concrete surfaces in accordance with ICRI Guideline No. 310.2R-2013 to achieve a concrete surface profile of CSP-3 or higher, or in accordance with manufacturer's requirements.
2. Remove existing joint sealant and backing materials, and mechanically prepare joint wall substrates per the sealant manufacturer's recommendations.
3. Expansion joint must be a minimum of 1/4" X 1/4".
4. Install Miracote Miraflex Membrane C in accordance with specifications and the manufacturer's installation guidelines.
5. Install Miracote BC Pro in accordance with specifications and the manufacturer's installation guidelines.
6. Sealant must be twice the width as the depth up to 1/2".
7. Tool flush and sprinkle oven dried sand immediately into sealant surface while wet.
8. Selected sealant must be rated for submersion.

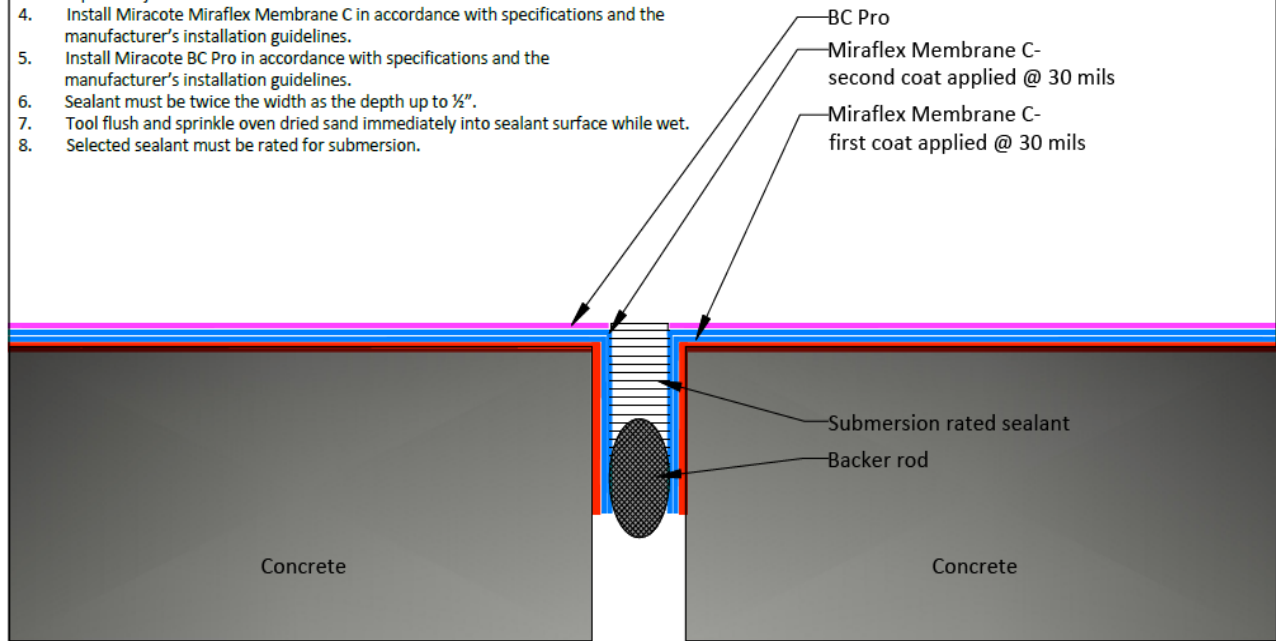

- |   |   |
|---|---|
| <p><b>Concrete surface preparation</b> <span style="color: red;">█</span></p> <ul style="list-style-type: none"> <li>• Concrete surface preparation of CSP-3 or higher</li> </ul> <p><b>Miraflex Membrane C</b> <span style="color: blue;">█</span></p> | <p><b>BC Pro</b> <span style="color: magenta;">█</span></p> <ul style="list-style-type: none"> <li>• Application rate at 30 mils depending upon surface and texture requirements</li> </ul> |
|---|---|

MIR-MEMC-PPF-EJD-2		EXPANSION JOINT DETAIL Pool Plaster Finishes	 <b>MIRACOTE</b> <i>Division of Crossfield Products Corp.</i>
4/19/20	NTS		