

CONSTRUCTION PLANS FOR:

**NATURAL GAS MAIN EXTENSION
GREAT VALLEY COMMERCE CENTER**

MATT SANTINI
MAYOR

CALVIN COOLEY
MAYOR PRO TEM

COUNCIL MEMBERS

KARI HODGE - WARD ONE
CARY ROTH - WARD THREE
GARY FOX - WARD FIVE

JAYCE STEPP - WARD TWO
CALVIN COOLEY - WARD FOUR
TAFF WREN - WARD SIX

DAN PORTA - CITY MANAGER
JULIA DRAKE - CITY CLERK
MICHAEL DICKSON - GAS SYSTEM DIRECTOR
BRIAN FRIERY - ASSISTANT GAS SYSTEM DIRECTOR



City of Cartersville

G A S S Y S T E M
P.O. Box 1390 • 155 Old Mill Road • Cartersville, Georgia 30120
Telephone: 770-387-5642 • Fax: 770-387-5638 • www.cityofcartersville.org

PROJECT NO. SP-21-005 DATE: JUNE 2022

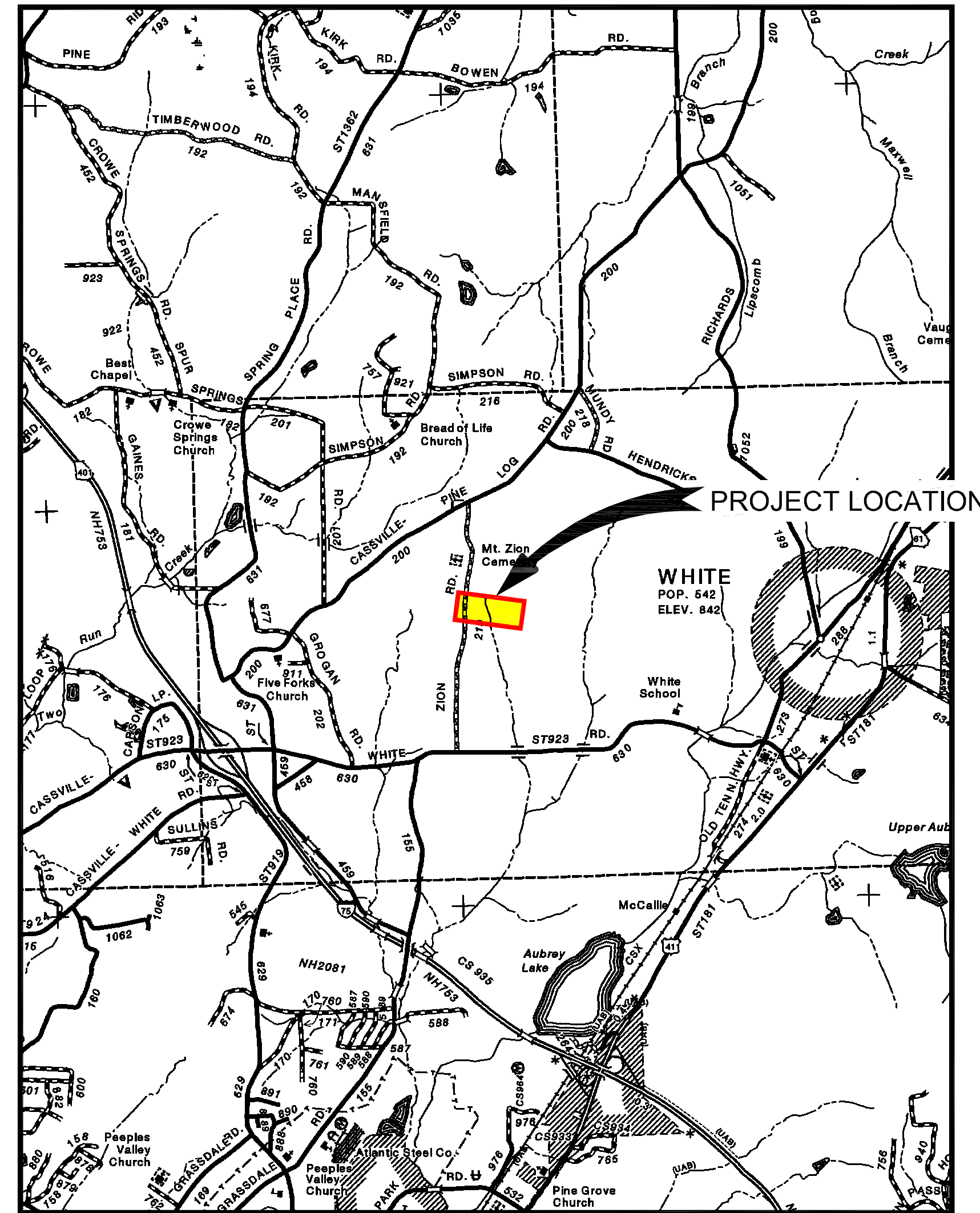
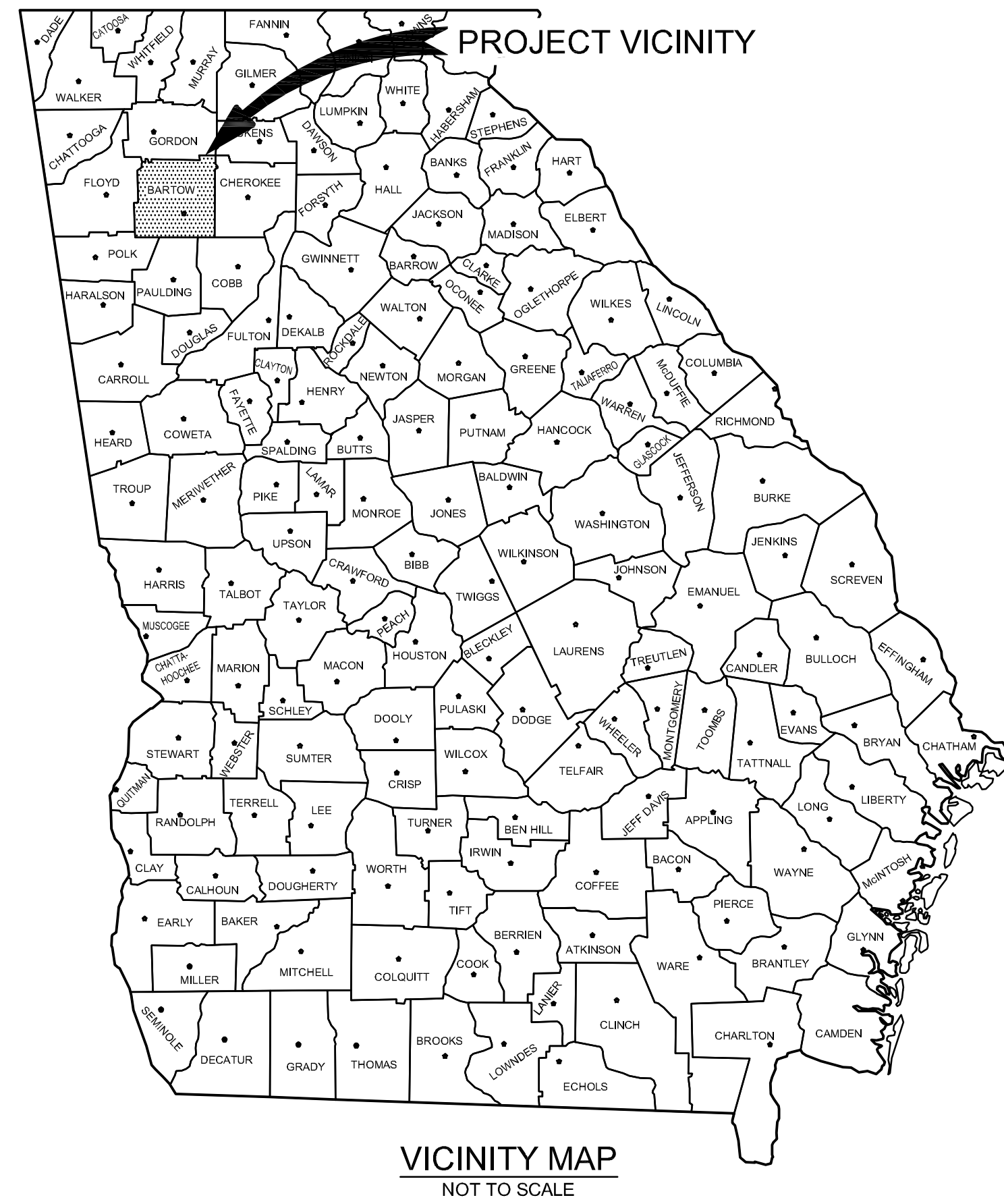

SHEET DESCRIPTION	SHEET NUMBER
DETAILS:	
LOCATION MAP-LEGENDS-GENERAL NOTES	DET-01
SILT & EROSION CONTROL DISTURBED AREA STABILIZATION	EC-DET-01
CONSTRUCTION PLANS:	
CONSTRUCTION PLAN: BEGIN PROJECT TO STA. 25+00	PLN-01
CONSTRUCTION PLAN: STA. 25+00 TO END PROJECT	PLN-02

- ### GENERAL NOTES
- Topographic data was obtained from construction plans prepared by Paulson Mitchell Incorporated of Roswell, Georgia by CAD file with the exception of the existing and proposed natural gas facilities owned and operated by the City of Cartersville, Georgia.
 - Proposed steel line pipe shall be installed with a cover of 48" from existing grade and shall be installed at greater depths where required by the plans or as directed. A minimum 24" separation shall be maintained between the proposed pipe and existing structures and utilities.
 - Marking tape shall be installed with a cover of 18" above the center line of all proposed steel pipe.
 - Locations of underground utilities shown on the plans are not guaranteed as to accuracy nor completeness. It shall be the Contractor's responsibility to request field locations through the Utility Protection Center and any utility owners thought to have facilities in the area.
 - It shall be the Contractor's responsibility to maintain a superintendent on the project at all times during construction with a thorough knowledge and understanding of the plans and specifications. The Contractor shall provide all necessary surveying, layout staking and expertise required to construct the proposed natural gas facilities at the locations shown in the plans.

LEGEND OF NATURAL GAS FACILITIES

	EXISTING HIGH-PRESSURE MAIN		PROPOSED MAGNESIUM ANODE
	EXISTING LOW-PRESSURE MAIN		EXISTING FLANGED LINE VALVE
	EXISTING POLYETHYLENE MAIN		EXISTING WELDED/FUSION LINE VALVE
	EXISTING MAIN TO BE ABANDONED		PROPOSED FLANGED LINE VALVE
	EXISTING ABANDONED MAIN		PROPOSED WELDED/FUSION LINE VALVE
	EXISTING CASING PIPE		EXISTING FARM TAP REGULATOR
	PROPOSED HIGH-PRESSURE MAIN		PROPOSED FARM TAP REGULATOR
	PROPOSED LOW-PRESSURE MAIN		EXISTING METER
	PROPOSED POLYETHYLENE MAIN		PROPOSED METER
	PROPOSED CASING PIPE		EXISTING CATHODIC PROTECTION RECTIFIER
	ONE-WAY FEED & DIRECTION		PROPOSED CATHODIC PROTECTION RECTIFIER
	TWO-WAY FEED & DIRECTION		EXISTING REGULATING STATION
	EXISTING CATHODIC PROTECTION TEST STATION		PROPOSED REGULATING STATION
	PROPOSED CATHODIC PROTECTION TEST STATION		
	EXISTING CATHODIC PROTECTION BOND STATION		
	PROPOSED CATHODIC PROTECTION BOND STATION		



Know what's below.
Call before you dig.

NATURAL GAS MAIN EXTENSION GREAT VALLEY COMMERCE CENTER	
LOCATION MAP-LEGENDS-GENERAL NOTES	
<p>City of Cartersville G A S S Y S T E M P.O. Box 1390 • 155 Old Mill Road • Cartersville, Georgia 30120 Telephone: 770-387-5642 • Fax: 770-387-5638 • www.cityofcartersville.org</p>	DESIGNED: B.S.F.
	DATE: JUNE 2022
	SCALE: NO SCALE
	PROJ NO: SP-21-005
	SHEET: DET-01

PERMANENT PLANT SPECIES, SEEDING RATES AND PLANTING DATES

SPECIES	RATES PER ACRE	RATES PER 1,000 SQ. FT.	PLANTING DATES BY MLRA			REMARKS
			M-L	P	C	
Bahia, Pensacola: Alone or with temporary cover With other perennials	60 lbs. 30 lbs.	1.4 lbs. 0.7 lb.	---	4/1-5/31	3/1-5/31	Low growing; sod producing; will spread into Bermuda lawns.
Bahia, Wilmington: Alone or with temporary cover With other perennials	60 lbs. 30 lbs.	1.4 lbs. 0.7 lb.	3/15-5/31	3/1-5/31	---	Same as above.
Bermuda, Common: (Hulled seed) Alone With other perennials	10 lbs. 6 lbs.	0.2 lbs. 0.1 lb.	---	4/1-5/31	3/15-5/31	Quick cover; low growing; sod forming; needs full sun.
Bermuda, Common: (Unhulled seed) With temporary cover With other perennials	10 lbs. 6 lbs.	0.2 lbs. 0.1 lb.	---	10/15-2/28	11/1-1/31	Plant with Winter annuals. Plant with Tall Fescue.
Bermuda Sprigs: Common lawn and Forage hybrids	40 cu.ft. Sod plugs 3'x3'	0.9 cu. ft.	4/15-6/15	4/1-6/15	4/1-5/31	1 cu. ft. = 650 sprigs; 1 bu = 1.25 cu. ft. or 800 sprigs
Crown Vetch: With winter annuals or cool season grasses	15 lbs.	0.3 lbs.	9/1-10/15	9/1-10/15	---	Mix with 30 lbs. Tall Fescue or 15 lbs. Rye; inoculate seed; plant only North of Atlanta.
Fescue, Tall: Alone With other perennials	50 lbs. 30 lbs.	1.1 lbs. 0.7 lbs.	3/1-4/1 or 8/15-9/30	8/15-10/15 or 2/15-4/15	---	Mix with perennial Lespedezas or Crown Vetch; not for droughty soils or heavy use areas.
Lespedeza, Sericea: Scarified Unscarified Seed-bearing hay	60 lbs. 75 lbs. 3 tons	1.4 lbs. 1.7 lbs. 138 lbs.	4/1-5/31 9/1-2/28 10/1-2/1	3/15-5/31 9/1-2/28 10/1-2/28	3/1-5/15 9/1-2/28 9/15-1/15	Widely adapted and low maintenance; takes 2-3 years to establish; inoculate seed with EL inoculate; mix with Weeping Lovegrass, Common Bermuda, Bahia or Tall Fescue. Mix with Tall Fescue or winter annuals. Cut when seed is mature but before it shatters. Add Tall Fescue or winter annuals.
Lespedeza, Ambro Virgata or Appalaw: Scarified Unscarified	60 lbs. 75 lbs.	1.4 lbs. 1.7 lbs.	4/1-5/31 9/1-2/28	3/15-5/31 9/1-2/28	3/1-5/15 9/1-2/28	Spreading growth with height of 18"-24"; good in urban area; slow to develop good stands; mix with Weeping Lovegrass, Common Bermuda, Bahia Tall Fescue or winter annuals; do not mix with Sericea Lespedeza; inoculate see with EL inoculate.
Lespedeza, Shrub (Lespedeza Bicolor or Lespedeza Thumbergii) Plants	3'x3' spacing		11/1-3/31	11/1-3/15	11/15-2/28	Plant in small clumps for wildlife food and cover.
Lovegrass, Weeping: Alone With other perennials	4 lbs. 2 lbs.	0.1 lb. 0.05 lb.	4/1-5/31	3/15-5/31	3/15-5/31	Quick cover; drought tolerant; grows well with Sericea Lespedeza on road-banks and other steep slopes; short lived.
Maidencane sprigs:	2'x3' spacing		2/1-3/31	2/1-3/31	2/1-3/31	For very wet sites such as riverbanks and shorelines. Dig sprigs locally.
Panicgrass, Atlantic Coastal:	20 lbs.	0.5 lb.	---	3/1-4/30	3/1-4/30	Grows well on coastal sand dunes; mix with Sericea Lespedeza but not on sand
Reed Canary Grass: Alone With other perennials	50 lbs. 30 lbs.	1.1 lbs. 0.7 lb.	8/15-10/15	9/1-10/15	---	Grows similar to Tall Fescue; for wet sites FLATWOODS
Sunflower, Aztec Maximilian:	10 lbs.	0.2 lb.	4/15-5/31	4/15-5/31	4/1-5/31	Mix with Weeping Lovegrass or other low growing grasses or legumes.
Switchgrass:	20 lbs.	0.4 lb.	4/1-5/31	4/1-5/31	4/1-5/31	For streambank plantings, drainage ditches, and wet areas.

1. Rates are for broadcast seed. If a seed drill is used, reduce the rates by one-half.
2. The resource areas are defined in the MLRAs of Georgia map.

SUGGESTED SEEDBED DEPTHS

SLOPE	SEEDBED DEPTH
3:1 or Flatter	Less than 4" Depth
2:1 to 3:1	1" to 4" Depth
2:1 or Steeper	Depressions every 6"-8" hand dug, if necessary

FERTILIZER, LIME & MULCH REQUIREMENTS

TYPES OF SPECIES	PLANTING YEAR	FERTILIZER (N-P-K)	RATE (LBS./ACRE)	N TOP DRESSING RATE (LBS./ACRE)	LIME RATE (TONS/ACRE)	MULCH RATE (TONS/ACRE)
Cool season grasses	First	6-12-12	1500	50-100	2	2-1/2
	Second	6-12-12	1000	---		
	Maintenance	10-10-10	400	30		
Cool season grasses and legumes	First	6-12-12	1500	0-50	2	2-1/2
	Second	0-10-10	1000	---		
	Maintenance	0-10-10	400	---		
Warm season grasses	First	6-12-12	1500	50-100	2	2-1/2
	Second	6-12-12	800	50-100		
	Maintenance	10-10-10	400	30		
Warm season grasses and legumes	First	6-12-12	1500	50	2	2-1/2
	Second	0-10-10	1000	---		
	Maintenance	0-10-10	400	---		

Ds3 DISTURBED AREA STABILIZATION (PERMANENT VEGETATION)

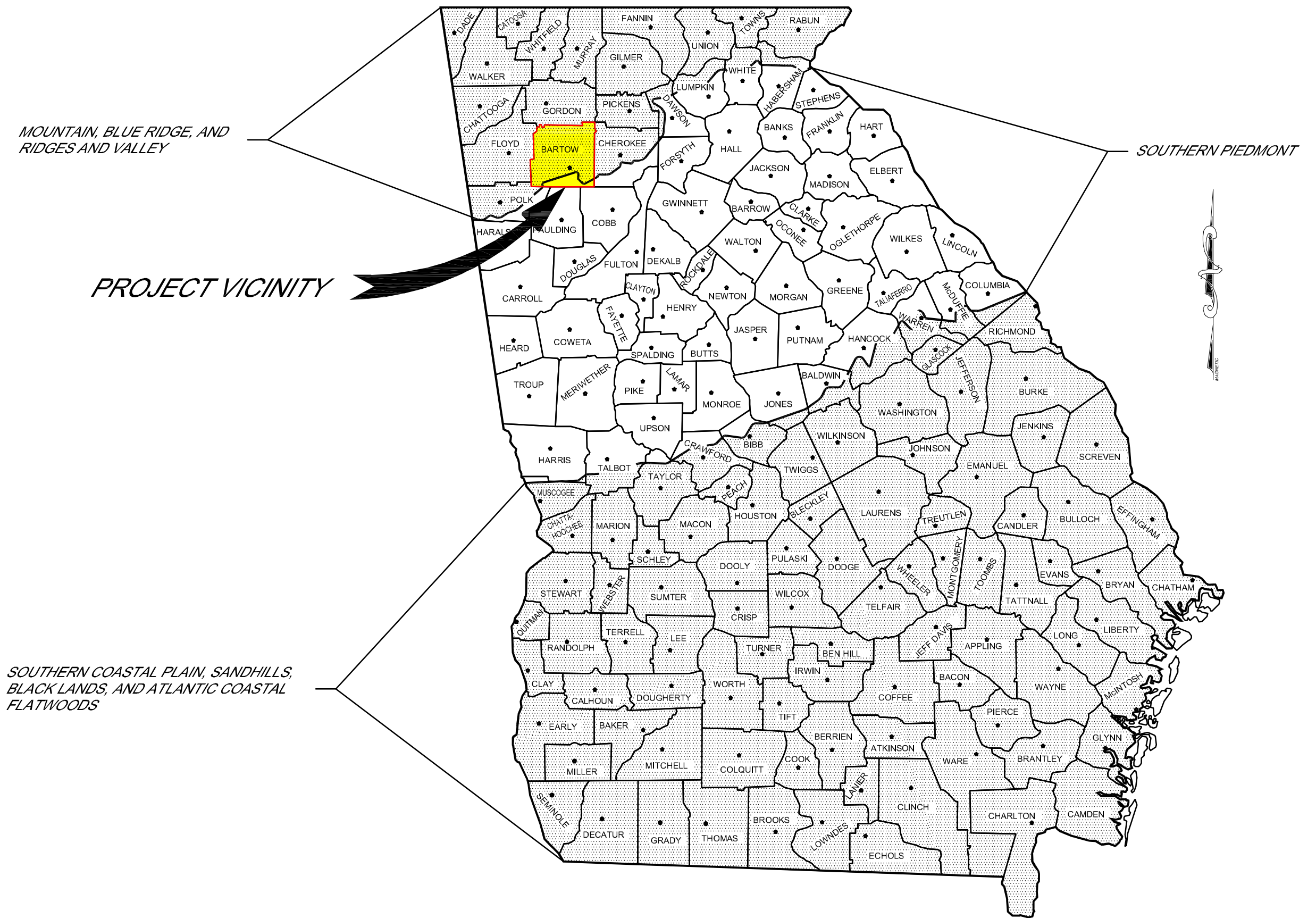

MAJOR LAND RESOURCE AREAS (MLRAs) OF GEORGIA

NOT TO SCALE

ACTIVITY SCHEDULE

DESCRIPTION OF ACTIVITY	MARCH				APRIL				MAY				JUNE				JULY				
	1st	2nd	3rd	4th	1st	2nd	3rd	4th	1st	2nd	3rd	4th	1st	2nd	3rd	4th	1st	2nd	3rd	4th	
Installation of silt & erosion control devices																					
Installation of pipeline & appurtenances																					
Maintenance of silt & erosion control devices																					
Dressing and permanent grassing																					
Removal of silt & erosion control devices																					

GENERAL SILT & EROSION CONTROL NOTES

- The construction of this project requires Best Management Practices (BMPs) in the prevention of sedimentation and the control of erosion. All silt and erosion control devices installed, constructed and maintained on this project shall conform to the standards and specifications set forth by the "Manual for Erosion and Sediment Control in Georgia", latest edition and must withstand up to a 25-year rainfall event.
- The Contractor will be responsible for the prevention of sedimentation and erosion control in all areas disturbed by construction until permanent grassing has been established and sedimentation and erosion is no longer evident. All areas disturbed shall be mulched and remain mulched until a permanent stand of grass is achieved.
- The Contractor will be responsible for the protection of all existing silt and erosion control devices installed and constructed under this project.
- All silt and erosion control devices installed in accordance with the erosion control plan shall be properly maintained at all times until permanent grassing has been established. In all areas disturbed by construction and sedimentation and erosion is no longer evident. Such silt and erosion control devices shall be cleaned of accumulated silt before the devices reach half full and all devices shall be maintained in good working order. The installer shall inspect such silt and erosion control devices for proper installation and working order on a daily basis and immediately following each rainfall event. Any such devices that become damaged or is not in proper working order shall be immediately remedied or replaced. All silt or sediment leaving such areas disturbed by construction shall be immediately removed, cleaned and restored to as near as original condition as possible. If necessary, additional silt and erosion control measures will be required outside the areas disturbed by construction to prevent further sedimentation and erosion.
- Once permanent grassing has been established in all areas where the Contractor has been required to install silt and erosion control devices and sedimentation and erosion is no longer evident, the Contractor shall properly remove all silt and erosion control devices from the project site.
- Portions of the silt and erosion control for this project are the responsibility of the site developer. The limits of the silt and erosion control required by these plans are shown on the plans.

NATURAL GAS MAIN EXTENSION
GREAT VALLEY COMMERCE CENTER
SILT & EROSION CONTROL
DISTURBED AREA STABILIZATION

City of Cartersville
G A S S Y S T E M
P.O. Box 1390 • 155 Old Mill Road • Cartersville, Georgia 30120
Telephone: 770-387-5642 • Fax: 770-387-5638 • www.cityofcartersville.org

DESIGNED: B.S.F.
DATE: JUNE 2022
SCALE: NO SCALE
PROJ NO: SP-21-005
SHEET: EC-DET-01

C:\BIBER\BIBER\PROJECTS\GAS\SP-21-005\DET-01.DWG JUN 08 2022 11:03AM

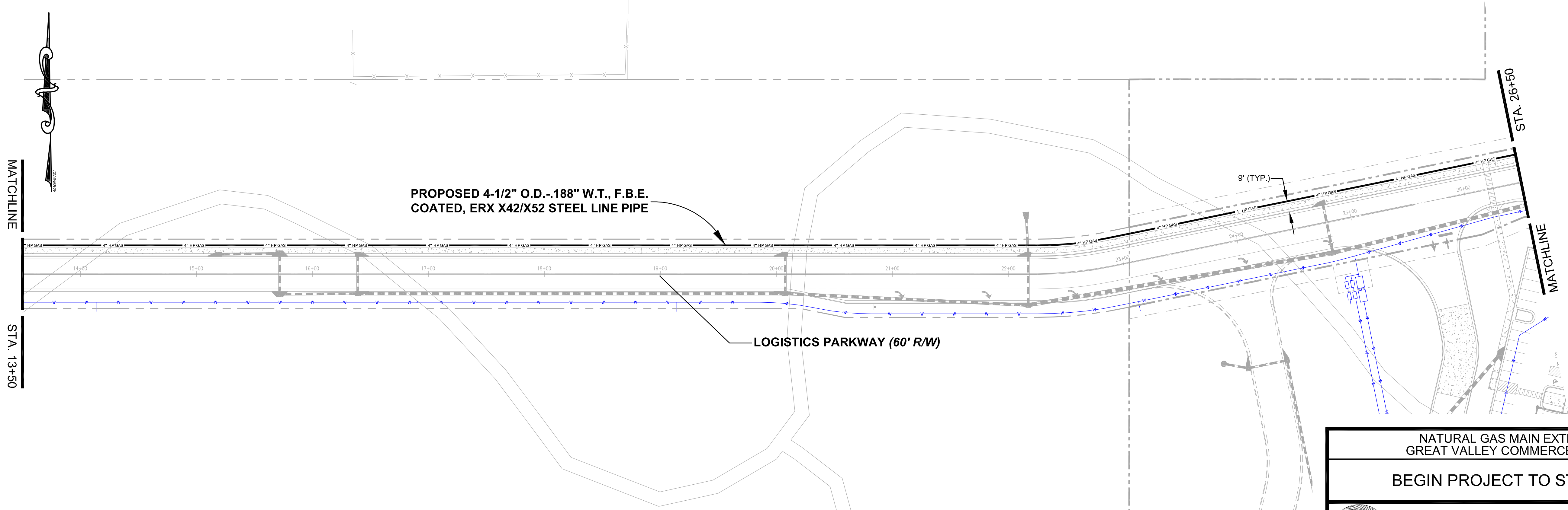
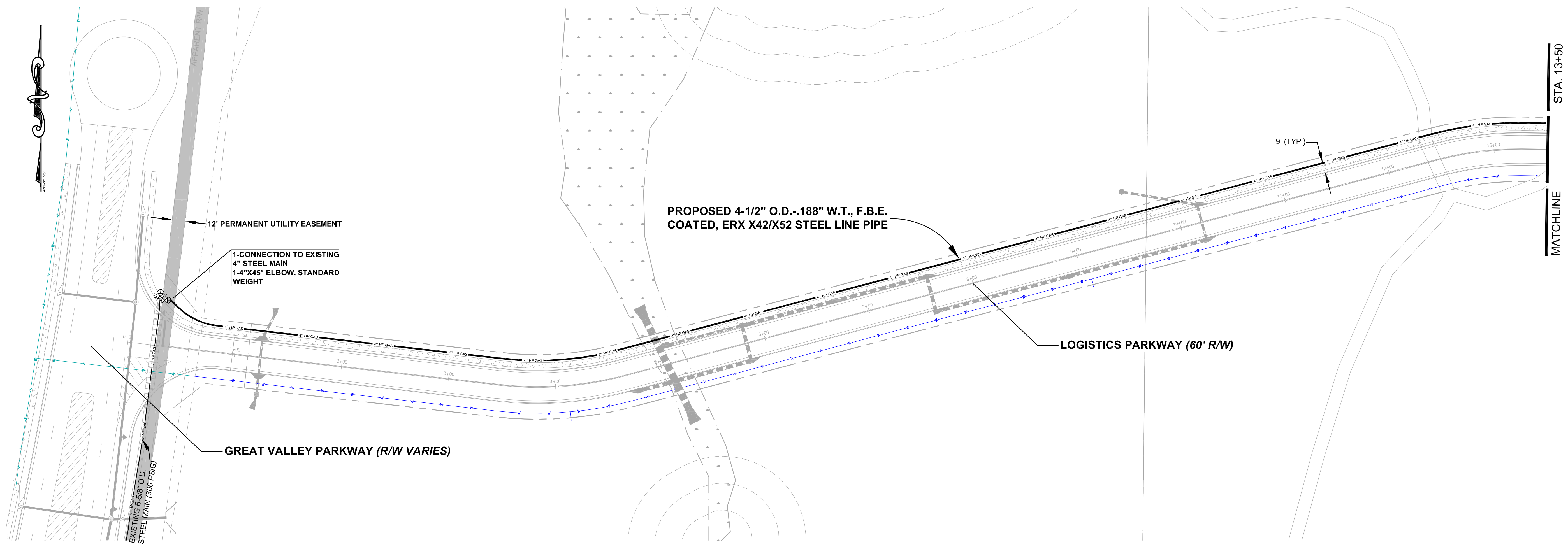

NATURAL GAS MAIN EXTENSION
GREAT VALLEY COMMERCE CENTER

BEGIN PROJECT TO STA. 13+50

<p style="font-size: 1.2em; font-weight: bold; margin: 0;">City of Cartersville</p> <p style="font-size: 0.8em; margin: 0;">G A S S Y S T E M</p> <p style="font-size: 0.7em; margin: 0;">P.O. Box 1390 • 155 Old Mill Road • Cartersville, Georgia 30120 Telephone: 770-387-5642 • Fax: 770-387-5638 • www.cityofcartersville.org</p>	DESIGNED: B.S.F.
	DATE: JUNE 2022
	SCALE: 1"=50'
	PROJ NO: SP-21-005
SHEET: PLN-01	

C:\BIBER\BIBER\DATA\LOCAL\TEMP\ACRIBIBI\252052-105-FINAL.DWG JUNE 06, 2022 10:58AM



MATCHLINE

STA. 26+50

PROPOSED 4-1/2" O.D.-.188" W.T., F.B.E. COATED, ERX X42/X52 STEEL LINE PIPE

LOGISTICS PARKWAY (60' R/W)

EXISTING SERVICE LINE TO BE CONNECTED BY OWNER

1-4" END CAP, STANDARD WEIGHT

NATURAL GAS MAIN EXTENSION
GREAT VALLEY COMMERCE CENTER

STA. 26+50 TO END PROJECT



City of Cartersville

G A S S Y S T E M
P.O. Box 1390 • 155 Old Mill Road • Cartersville, Georgia 30120
Telephone: 770-387-5642 • Fax: 770-387-5638 • www.cityofcartersville.org

DESIGNED: B.S.F.
DATE: JUNE 2022
SCALE: 1"=50'
PROJ NO: SP-21-005
SHEET: PLN-02

C:\BIB\BIB\APPDATA\LOCAL\TEMP\ACRIBUS\2528152-105-FIN.DWG - JUNE 06, 2022 - 10:58AM